

SEB2-F2,8

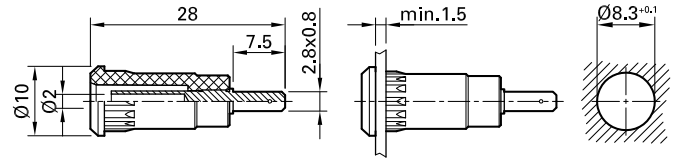

Item number 65.9099-*

Insulated, rigid, accepting spring-loaded \varnothing 2 mm plugs with rigid insulating sleeve. The socket is pressed into pre-drilled panels of plastic, metal, etc. Connection: Flat connecting tab 2.8 mm x 0.8 mm.

Technical data	
Diameter of plug system	2 mm
Rated Values	600 V, CAT III, 10 A
Surface treatment electrical contact	Au
Base material electrical contact	CuZn
Colours *	21 22 23 24 25 29
Test accessory acc. to	IEC EN 61010-2-030
Remarks	Accessories: Flat connecting receptacle FSH2,8x0,8; Press-in tool MB2-S