

1

2

3

4

5

6

7

**Male**

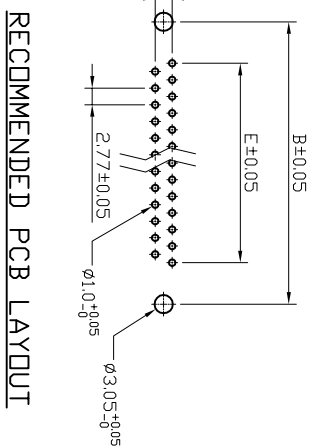
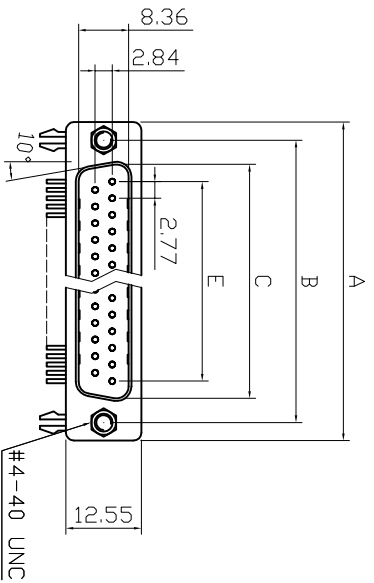

Product Specification  
 Material  
 Insulator : Glass-Filled thermoplastic PBT  
 UL94V-0 rated

Contact : Brass  
 Shell : Steel

Electrical  
 Contact Resistance : 20 milliohms  
 Max at 1 AMP DC.  
 Insulation Resistance : 1000  
 megohms at 500 VDC

Dielectric Withstanding Voltage :  
 1000 VAC/rms 60Hz for 1 minute

Current Rating : 5AMP

Voltage Rating : 250 VAC/rms 60Hz

① Solder temp for wave soldering : 220 ± 5°C, 3--5 s

Order Code:

A-Dx xx A/KG-xx

\* on request

Contact style:  
 F - Female  
 S - Male

Version  
 T3 - with locking bolts UNIC  
 T3 - without locking bolts\*

No. of Contacts  
 09 / 15 / 25 / 37

Standard: Quality class III

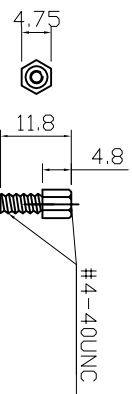
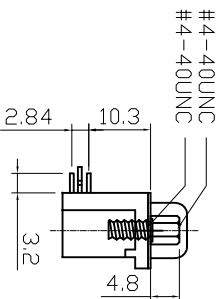
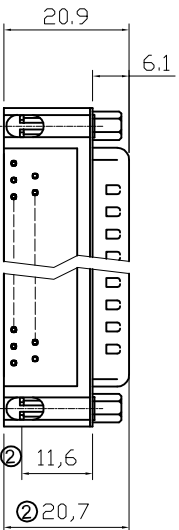

Dimensions

Positions	A	B	C	E
9	30.81	24.99	16.92	11.08
15	39.20	33.30	25.25	19.39
25	53.05	47.04	38.96	33.24
37	69.40	63.50	55.42	49.86

9.4mm Footprint

**RoHS compliant**

Unit:mm



File No.: E198287

Scale	Free																	
TOLERANCE																		
X.	±0.38																	
X.X	±0.25																	
X.XX	±0.13																	
DIM	TOL																	
X.°	±3°																	
X.X°	±1.0°																	
Angle	TOL																	

Scale	Free																	
TOLERANCE																		
X.	±0.38																	
X.X	±0.25																	
X.XX	±0.13																	
DIM	TOL																	
X.°	±3°																	
X.X°	±1.0°																	
Angle	TOL																	

Customer-No.

Date

Name

ASSMANN WSW-No.

A-Dx xx A/KG-T1/T3

Drawing-No.

ASS 4889 CO

rev03

Sheet 1/2



1

2

3

4

5

6

7

H

G

F

E

D

C

B

A

1

2

3

4

5

6

7

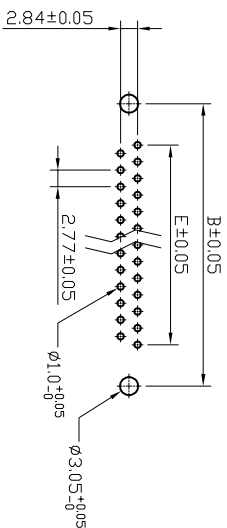
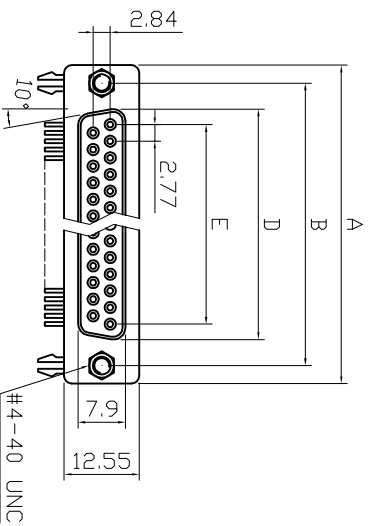
**Female**

**RECOMMENDED PCB LAYOUT**  
**FEMALE\MALE**

- Product Specification  
Material  
Insulator : Glass-Filled thermoplastic PBT  
UL94V-0 rated
- Contact : Phosphor bronze  
Shell : Steel : 7439-89-6  
100u" Tin over 80u" Min Copper  
Clinch Nut : Copper alloy, Nickel Plated.  
Boardlock : Brass, Tin Plated.  
Screwlock : Brass, Nickel Plated.  
Electrical
- Contact Resistance : 20 milliohms  
Max at 1 AMP DC.  
Insulation Resistance : 1000  
magohms at 500 VDC  
Dielectric Withstanding Voltage :  
1000 VAC/rms 60Hz for 1 minute  
Current Rating : 3AMP  
Voltage Rating : 250 VAC/rms 60Hz  
Temperature Range: -20°C ~ 85 °C  
① Solder temp for wave soldering :220 ± 5°C,3-5 s

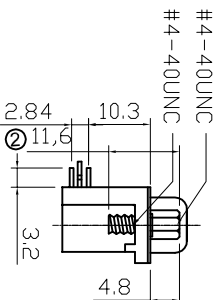
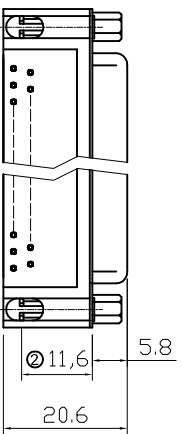

9.4mm Footprint

Dimensions		A	B	D	E
Positions	9	30.81	24.99	16.33	11.08
	15	39.20	33.30	24.70	19.39
	25	53.05	47.04	38.40	33.24
	37	69.40	63.50	54.80	49.86

**ROHS compliant**  
Unit:mm



Scale	Free								
<b>TOLERANCE</b>									
X.	±0.38								
X.X	±0.25	③	Add the UL number	11.12.2015	Winnie	Drawn	15.08.2012	Lucas	
X.XX	±0.13	②	Update the dimension	27.02.2015	Winnie	Approved	11.12.2015	Winnie	
<b>DIM</b>									
X.°	±3°	①	Add the soldering temperature	24.01.2014	Winnie				
X.X°	±1.0°	①	Drawn	15.08.2012	Lucas				
Angle	TOL	Id.	Modification	Date	Name				

Customer-No.

ASSMANN WSW-No.

A-DX XX A/KG-T1/T3

Drawing-No.

ASS 4889 CO

rev03

Replace

Sheet 2/2

1

2

3

4

5

6

7

H

G

F

E

D

C

B

A

H

G

F

E

D

C

B

A