

1

2

3

4

5

6

7

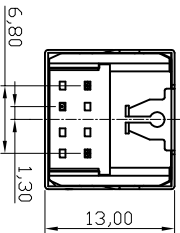
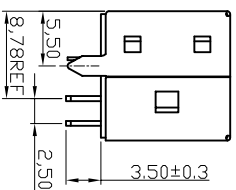
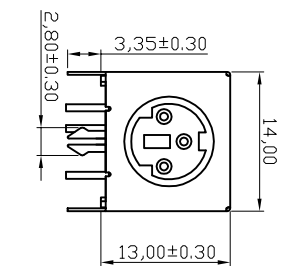

1. Material:
 - Contacts : Brass
 - Insulator : PBT+30% G.F. UL 94V-0-Black
 - Shell : Brass
2. Mechanical:
 - Mating Force: 45N max.
 - Withdrawal Force: 7N min.
 - Durability: 500 cycles min.
3. Electrical:
 - Current-max[amps] 1.0A
 - Voltage-max[volts] 30V
 - Withstanding Voltage 750V AC
 - Contact Resistance [ohms] 30 milliohms max
 - Insulation Resistance [ohms] 1000 Megohms min
4. Plating:
 - Contacts: Gold Flash Selective over Nickel
 - Shell: Nickel
5. Environmental
 - Temperature Range -55°C~+85°C

A-DIO-FSxx

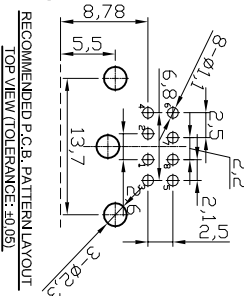
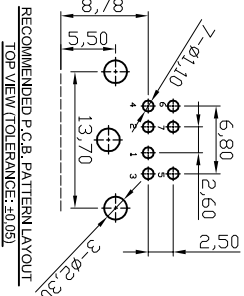
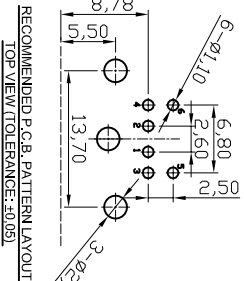
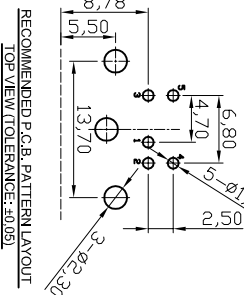
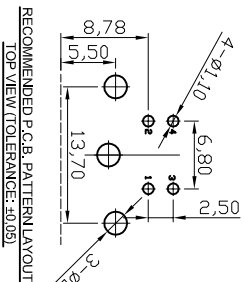
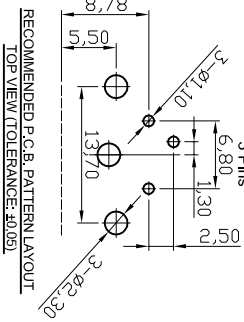
 Shielded No. of Contacts
 03 / 04 / 05 / 06 / 07 / 08

RoHS compliant
Unit:mm

Scale	Free								
TOLERANCE	⑥	Correct the pin out	29.04.2014	Winnie	Drawn	19.03.2004	Hellwig	ASSMANN WSW-No.	Customer-No.
X.X	⑦	Update	31.07.2012	Lucas	Approved	29.04.2014	Winnie	A-DIO-FSXX	
X.XXX	⑧	Change the manufacture plant	25.11.2010	Alex					
DIM	②	Update	15.07.2009	Rate					
X.°	①	Drawn	19.03.2004	Hellwig					
X.X°									
Angle	TOL	Id.	Modification	Date	Name				

ASSMANN
WSW/ components

ASSMANN WSW-No.
A-DIO-FSXX

ASS 1622 CO

rev05

Sheet

1

2

3

4

5

6

7

H

G

F

E

D

C

B

A