

ROHS Compliant



# 台灣駿品端子股份有限公司

TAIWAN KING PIN TERMINAL CO.,LTD

台北縣樹林市俊德街 23 號

TEL:886-2-26895596.26886112 FAX:886-2-26886110  
E-mail:info@tkp.com.tw http://www.tkp.com.tw

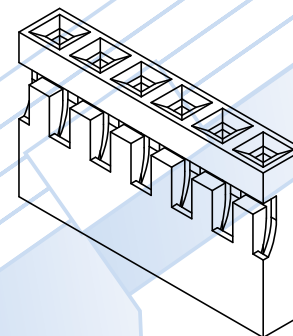
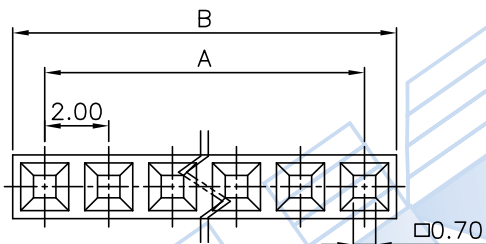

- NOTE :**
- \* Material : PBT UL 94V-0 (Lead Free)
  - \* Standard color : Black
  - \* Electrical rating : UL 125V 1A, AC/DC  
CSA 250V 1A, AC/DC
  - \* Accepts AHT(LF) terminal
  - \* Mates with AH11(LF), AH1L(LF) series headers
  - \* 2-40 circuits available

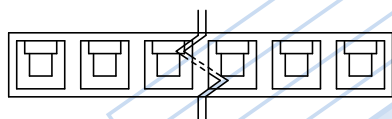
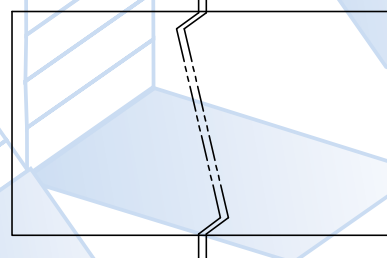
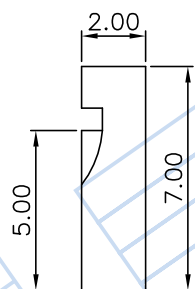
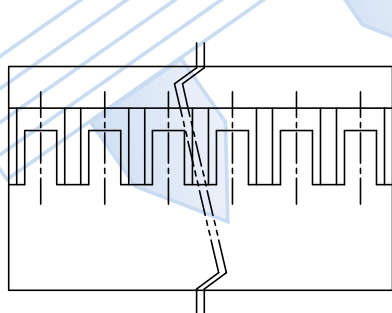

CIRCUITS	PART NO.	DIM. A	DIM. B	CIRCUITS	PART NO.	DIM. A	DIM. B
2	AH1-1x2(LF)	2.00	4.20	22	AH1-1x22(LF)	42.00	44.20
3	AH1-1x3(LF)	4.00	6.20	23	AH1-1x23(LF)	44.00	46.20
4	AH1-1x4(LF)	6.00	8.20	24	AH1-1x24(LF)	46.00	48.20
5	AH1-1x5(LF)	8.00	10.20	25	AH1-1x25(LF)	48.00	50.20
6	AH1-1x6(LF)	10.00	12.20	26	AH1-1x26(LF)	50.00	52.20
7	AH1-1x7(LF)	12.00	14.20	27	AH1-1x27(LF)	52.00	54.20
8	AH1-1x8(LF)	14.00	16.20	28	AH1-1x28(LF)	54.00	56.20
9	AH1-1x9(LF)	16.00	18.20	29	AH1-1x29(LF)	56.00	58.20
10	AH1-1x10(LF)	18.00	20.20	30	AH1-1x30(LF)	58.00	60.20
11	AH1-1x11(LF)	20.00	22.20	31	AH1-1x31(LF)	60.00	62.20
12	AH1-1x12(LF)	22.00	24.20	32	AH1-1x32(LF)	62.00	64.20
13	AH1-1x13(LF)	24.00	26.20	33	AH1-1x33(LF)	64.00	66.20
14	AH1-1x14(LF)	26.00	28.20	34	AH1-1x34(LF)	66.00	68.20
15	AH1-1x15(LF)	28.00	30.20	35	AH1-1x35(LF)	68.00	70.20
16	AH1-1x16(LF)	30.00	32.20	36	AH1-1x36(LF)	70.00	72.20
17	AH1-1x17(LF)	32.00	34.20	37	AH1-1x37(LF)	72.00	74.20
18	AH1-1x18(LF)	34.00	36.20	38	AH1-1x38(LF)	74.00	76.20
19	AH1-1x19(LF)	36.00	38.20	39	AH1-1x39(LF)	76.00	78.20
20	AH1-1x20(LF)	38.00	40.20	40	AH1-1x40(LF)	78.00	80.20
21	AH1-1x21(LF)	40.00	42.20				



PART NO.	Material	Color	Remark	APPROVAL
AH1-1xX(LF)				DRAWN: 高琇瑩
TITLE	2.00mm Wire to Board			CHECKED: 張明遠
THIRD ANGLE	SCALE	UNIT	SHEET NO	TOLERANCE
	3:1	mm	1/1	.X± 0.30 .XXX±0.10 .XX± 0.20 ANGLE±2°
	200-004		A200-001	DATE: 2011.10.13 ODD NUMBERS: ENG951107 REV: A2
				APPROVED: 陳泓宇