



# B4MASK



<b>TYPICAL APPLICATIONS</b>	Outdoor electrical equipments, pumps, high pressure cleaners
<b>FUNCTIONS</b>	<ul style="list-style-type: none"> <li>■ SPST</li> <li>■ DPST, illuminated or not</li> <li>■ DPCO</li> </ul>
<b>PROTECTION DEGREE</b>	IP 65
<b>CYCLE No.</b>	50.000
<b>CUT OUT</b>	30x22 mm
<b>AMBIENT TEMPERATURE</b>	120 °C
<b>GWT</b>	850 °C
<b>GWT NO FLAME (&lt;2sec)</b>	750 °C on demand

**B 4 M A S K**

**?**

## DRAWING

## TERMINAL

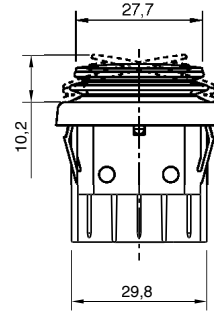
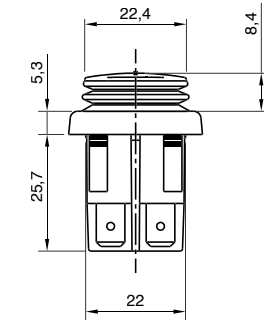

**1** Gloss version

**3** Mat version

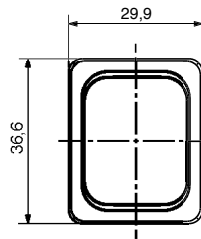
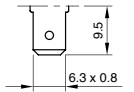

→ Available in Gloss or Mat

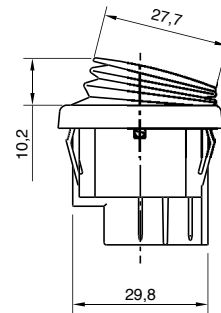
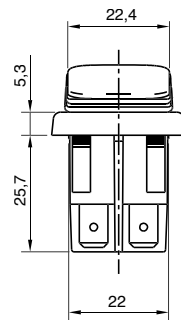

**4** Gloss version

**5** Mat version

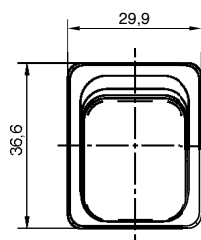
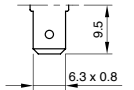

→ Available in Gloss or Mat

**L** Gloss version

**P** Mat version

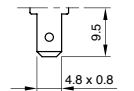

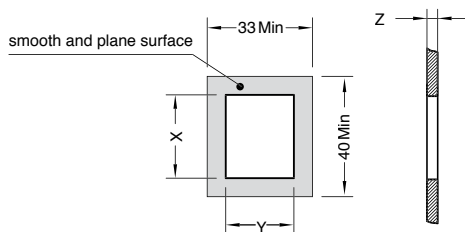

Z	Y	X
0,75 ... 1,25	22,0 $^{+0,2}_0$	30,2 $\pm 0,1$
1,25 ... 2,0	22,0 $^{+0,2}_0$	30,6 $\pm 0,1$
2,0 ... 3,0	22,0 $^{+0,2}_0$	30,8 $\pm 0,1$

TERMINAL	FUNCTION	RATING	RUBBER COLOUR	ROCKER COLOUR	MARKING COLOUR	MARKING
B	4	M	A	S	K	0 0 0

?	?	?	?	?	?	?	0	0	0
FUNCTION	RATING	RUBBER COLOUR	ROCKER COLOUR	MARKING COLOUR	MARKING				

**1**

**2**

**8**

**9** Terminal 1 - 3

**C**

**Function 9**

**16 (6) A / 250 VAC**  
**10 (4) A / 250 VAC - 5E4**  
**T120/55 °C**  
**EN 61058**

20 A / 125 VAC  
 16 A / 250 VAC  
 1/3 HP - 125 VAC  
 3/4 HP - 250 VAC  
 T105 °C  
 UL 1054  
 CSA C22.2

**E**

**Function 1**

**16 (8) A / 250 VAC**  
**12 (10) A / 250 VAC - 5E4**  
**T120 / 55 °C**  
**EN 61058**

20 A / 125 VAC  
 16 A / 250 VAC  
 1/3 HP - 125 VAC  
 3/4 HP - 250 VAC  
 T105 °C  
 UL 1054  
 CSA C22.2

**N**

**Function 2 - 8**

**16 (8) A / 250 VAC**  
**12 (10) A / 250 VAC - 5E4**  
**T120/55 °C**  
**EN 61058**

20 A / 125 VAC  
 16 A / 250 VAC  
 3/4 HP - 125 / 250 VAC  
 T105 °C  
 UL 1054  
 CSA C22.2

**S**

**Function 2 - 8**

**20 (10) A / 250 VAC**  
**14 (14) A / 250 VAC - 5E4**  
**T120/55 °C**  
**EN 61058**

25 A / 125 VAC  
 16 A / 250 VAC  
 3/4 HP - 125 / 250 VAC  
 T105 °C  
 UL 1054  
 CSA C22.2

**1**

black

**1**

black

**2**

white

**3**

orange

**ILLUMINATED**

**G**

red

**E**

green

**L**

white

**F**

blue

**BRIGHT**

**A**

orange

**V**

green

**X**

custom

**0**

none

**1**

black

**2**

white

**X**

custom

**0**

**1**

**A**

**9**

**X**