

1		2		3		4		5		6		7		8	
REVISIONS															
ISS	ZONE	DESCRIPTION\PER REQUEST\DATE													

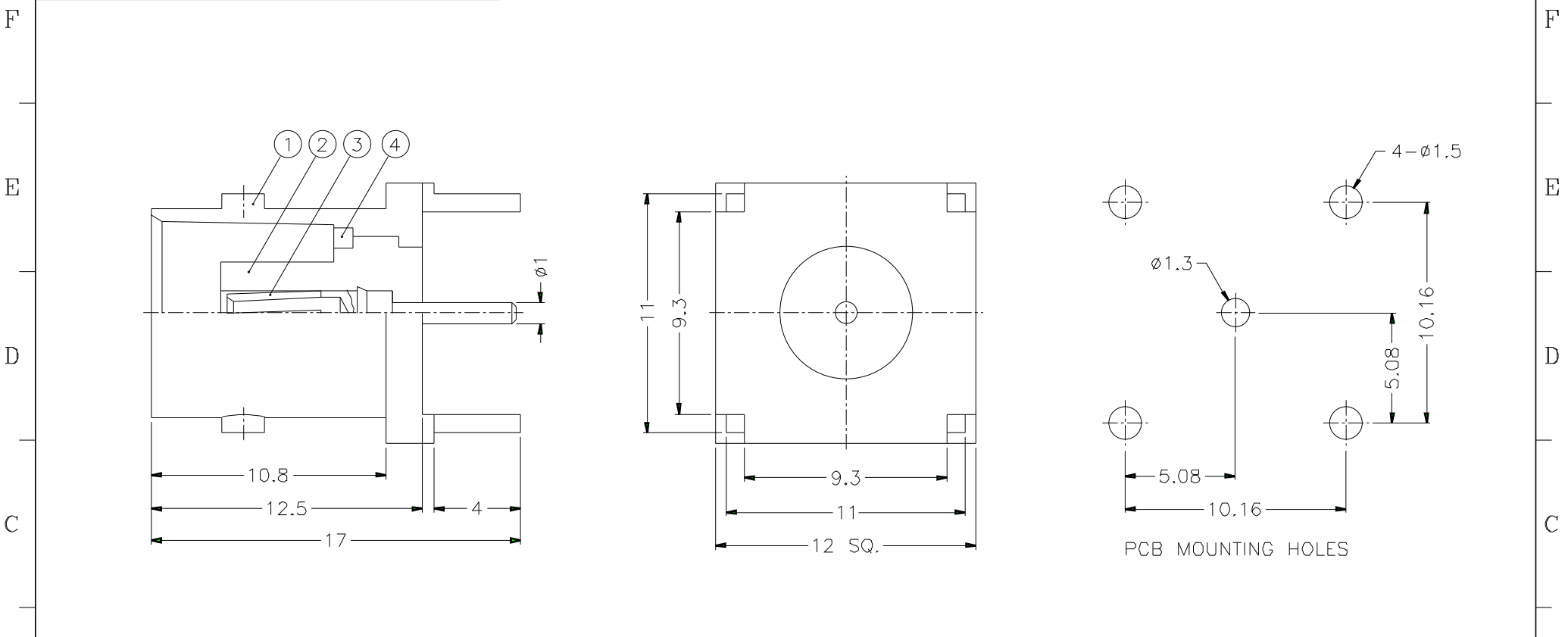

NOTES: FINISH (PLATING THICKNESS IN MICRO-INCHES)
 1. BRASS PER QQ-B-626
 2. BRASS PER QQ-B-613
 3. NICKEL PL. 100 MIN. THICK OVER COPPER STRIKE
 4. PHOSPHOR BRONZE PER QQ-B-750
 5. GOLD PL. 3 MIN. THICK OVER NICKEL PL. 100 MIN. THICK OVER COPPER STRIKE
 6. TEFLON MIL-P-19468

DIMENSIONS ARE IN MILLIMETERS										PART NO. B6251F1-NT3G-50		Amphenol					
UNLESS OTHERWISE SPECIFIED TOLERANCES										APPROVED						DATE	
0.5-6 = ±0.2										CHECKED		DATE		TITLE			
6-30 = ±0.4										DRAWN		DATE		BNC P.C. MOUNT RECEPT. JACK			
30-120 = ±0.6														DRAWING NO.			
120-315 = ±1														KJ-B6251F1-NT3G-50			
315-1000 = ±1.6														ITEM NO.			
1000-2000 = ±2.4																	
4	LOCK RING	NOTE 2	NOTE 3	1	B7700-4	SCALE	4/1	ISSUE	A	FILE NO.							
3	CONTACT PIN	NOTE 4	NOTE 5	1	B7702-3												
2	INSULATOR	NOTE 6	NATURAL	1	B7702-2T-50												
1	BODY	NOTE 1	NOTE 3	1	B7702-1-B												
NO.	DESCRIPTION	MATERIAL	FINISH	Q'TY	DRAWING NO.												

1		2		3		4		5		6		7		8	
---	--	---	--	---	--	---	--	---	--	---	--	---	--	---	--