

2.54mm pitch Female Header

- THT - side entry type

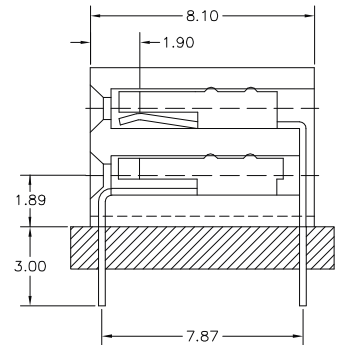
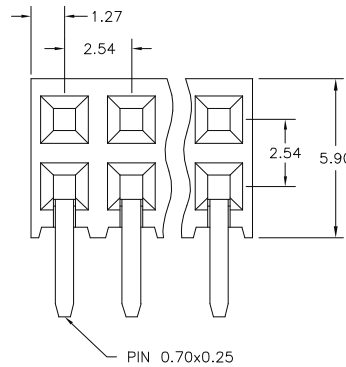
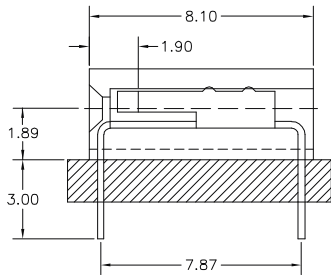
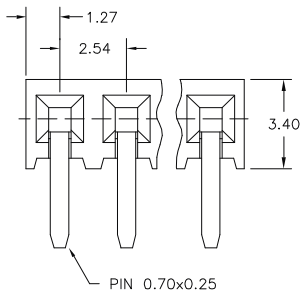
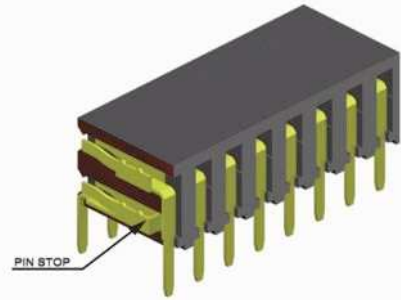
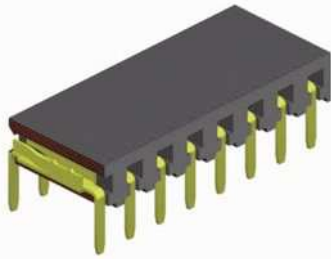

### APPLICATION AND FEATURES

- Hi-rel dual beam contact assures reliable PC-board connections
- Accepts 0.64mm square pins
- Stand-off's facilitate post solder cleaning
- 3.40mm and 5.90mm height above board

### PCB Hole Layout

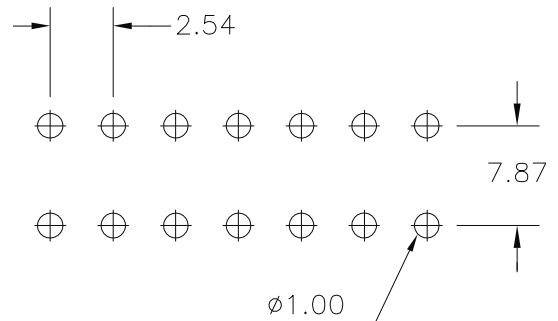

### SPECIFICATIONS

Current rating	3 A
Insulator resistance	1000 MΩ min.
Contact resistance	20 mΩ max.
Withstanding voltage	500 V AC

Operating temperature	- 40°C to + 105°C
Contact material	(RoHS compliant) Phosphor Bronze
Insulator material	(RoHS compliant) P.B.T. UL 94 V-0

### How to order

BH x - xxx - R850 - 55

Rows
<b>1</b> = single row
<b>2</b> = dual row

Nbr of contacts
single row = <b>003</b> to <b>040</b>
dual row = <b>004</b> to <b>080</b>

Plating
<b>55</b> = gold
Other platings on request