

2.54mm pitch Female Header  
 - THT - 5.70mm profile

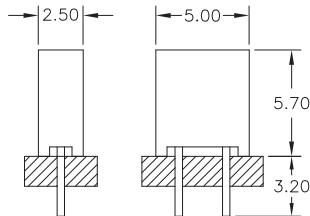

S 570

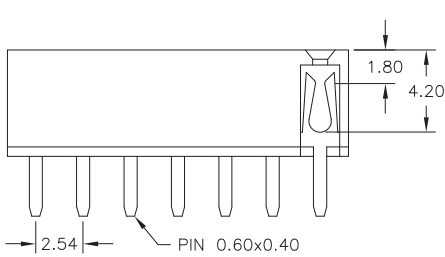
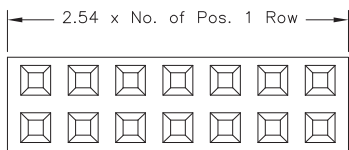
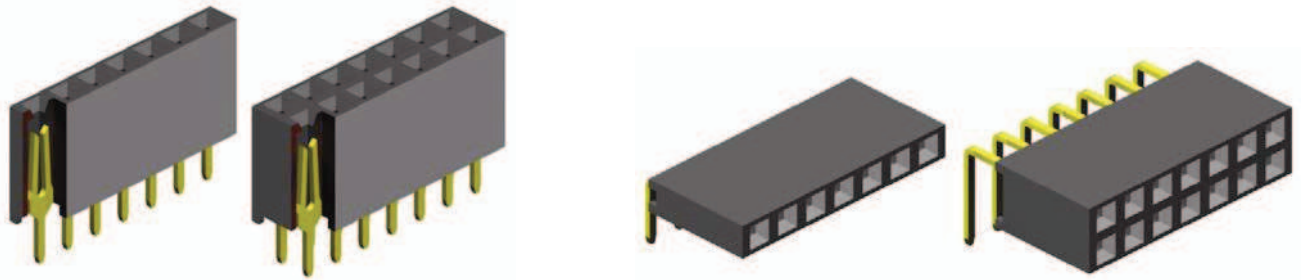
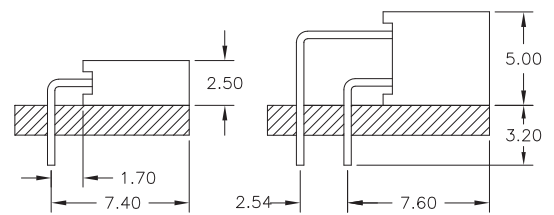

R 570

**SPECIFICATIONS**

Current rating	3 A
Insulator resistance	1000 MΩ min.
Contact resistance	20 mΩ max.
Withstanding voltage	500 V AC
Operating temperature	- 40°C to +105°C
Contact material	Brass
Insulator material	P.B.T. UL 94 V-0

**PCB Hole Layout**

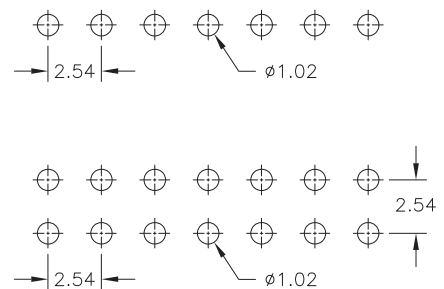

**How to order**

BL x - xxx - X 570 - 55

Rows	Nbr of contacts	Connector style	Plating
<b>1</b> = single row <b>2</b> = dual row	single row = <b>002</b> to <b>040</b> dual row = <b>004</b> to <b>080</b>	<b>S 570</b> = straight <b>R 570</b> = right angle	<b>55</b> = gold  Other platings on request