

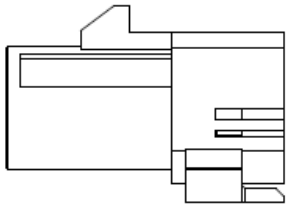

APPLICATION SPECIFICATION

SHROUD



BODY

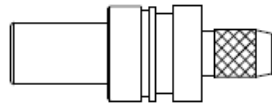

CONTACT PIN



CRIMP TUBE

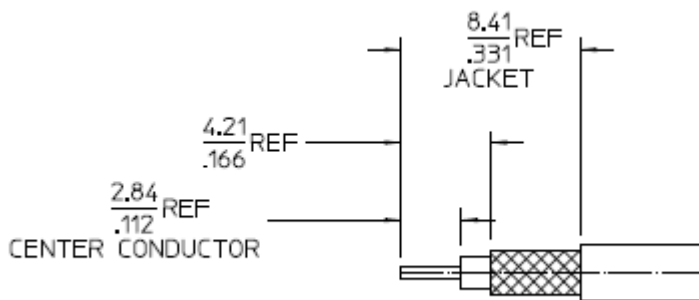
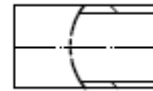

1. STRIP CABLE DIMENSIONS AS SHOWN.

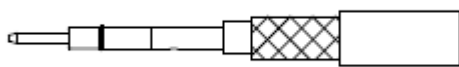

2.1 SLIDE CRIMP TUBE OVER THE CABLE JACKET.

2.2 INSERT CABLE CENTER CONDUCTOR INTO CONTACT, AS SHOWN

2.3

A. CRIMPING CONTACT PIN WITH HAND CRIMP TOOL.

HAND TOOL

DANIELS AFM8 (Depth Setting 4)



OR

B. CRIMPING CONTACT PIN WITH SOLDER (AWG. 26 AND AWG. 30).

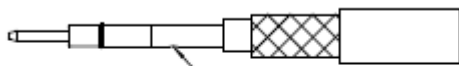

SOLDER

REVISION:

A

ECR/ECN INFORMATION:

EC No: **URF2013-0510**

DATE: **2013/ 06 / 13**

TITLE:

**FAKRA II CABLE ASSYMBLY
INSTRUCTIONS FOR 73403-628X
HAND TOOL**

SHEET No.

1 of 2

DOCUMENT NUMBER:

AS-73597-046

CREATED / REVISED BY:

EVITA

CHECKED BY:

APPROVED BY:



APPLICATION SPECIFICATION

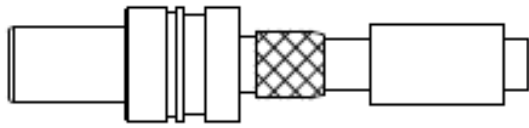

3. INSERT CABLE /CABLE ASSEMBLY INTO CONNECTOR BODY TO THE INTERFACE DIMENSION, AS SHOWN.

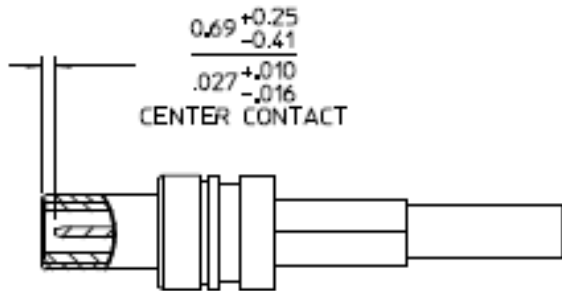

4. SLIDE CRIMP TUBE OVER BRAID UNTIL BOTTOM AND CRIMP USING 3.25mm (.128) HEX DIE. USING HAND CRIMP TOOL.

HAND TOOL

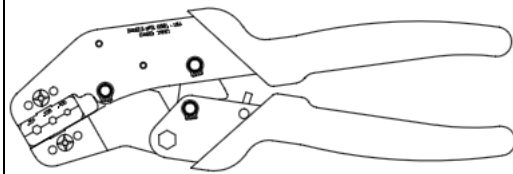

CRIMPING DIES



HAND TOOL W/ DIE (Part NO: 73415-4550)

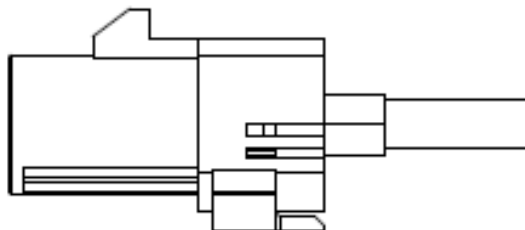

5. INSERT SUB ASSY (STEP 4) INTO THE SHROUD

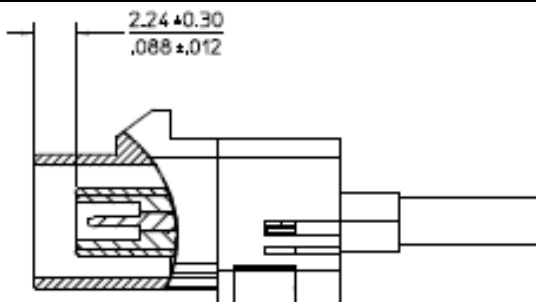

6. PRESS THE CLIP INTO IT.

<u>REVISION:</u> A	<u>ECR/ECN INFORMATION:</u> EC No: URF2013-0510 DATE: 2013/ 06 / 13	<u>TITLE:</u> FAKRA II CABLE ASSYEMBLY INSTRUCTIONS FOR 73403-628X HAND TOOL	<u>SHEET No.</u> 2 of 2
<u>DOCUMENT NUMBER:</u> AS-73597-046		<u>CREATED / REVISED BY:</u> EVITA	<u>CHECKED BY:</u> <u>APPROVED BY:</u>
<small>TEMPLATE FILENAME: APPLICATION_SPEC(SIZE_A4)(V.1).DOC</small>			