

**HEADERS  
FOR P.C.B.**

**CONNETTORI MASCHIO  
PER C.S.**

**CONNECTEURS MÂLE  
POUR C.I.**

**STIFTLISTE  
FÜR LEITERPLATTEN**

Pitch Pas	Passo Rastermaß	mm
Rated Voltage Tensione nominale Tension nominale	Tensione nominale Bemessungsspannung	V
Rated Current Intensità nominale	Corrente nominale Bemessungsstrom	A

Temperature Température	Temperatura Temperatur	°C
Housing Corps isolant	Corpo isolante Isolierkörper	

	IMQ	EN61984
	VDE	EN61984
	cUL	UL1059 + C22.2 n°158

Poles Pôles	Poli Polzahl	X
Colours Couleurs	Colori Farben	Y
Other information Autres données	Altri dati Weitere Informationen	D.

How to order Référence de commande		Ordinazione Bestellschlüssel	
CPM	5 / X	FV	Y N...
Type	Pitch	Poles	Version
Tipo	Passo	Polli	Versione
Type	Pas	Pôles	Version
Typ	Rastermaß	Polzahl	Version
			Colors
			Colori
			Farben
			Marquage
			Bedruckung

**CPM..FV CPM..SQ\*FV**

Single block · Blocco unico  
Monobloc · Einzelblock

Poles · Poli · Pôles · Polzahl

2/20

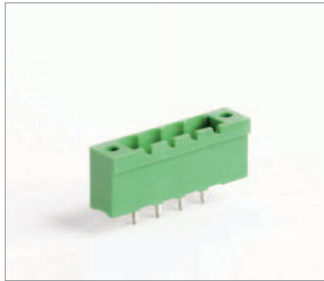

5 - 5,08
320
20

110
PA - UL 94 V0

V	A	mm²/AWG
320	20	0,2 ÷ 2,5
320	20	0,2 ÷ 2,5
300	12	24 ÷ 12

min 2 - max 20		
VE	/ on demand	GR GR1 NE AR BL RO GI
D/B4		

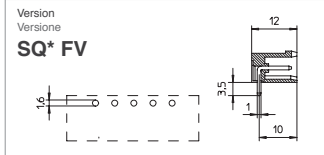
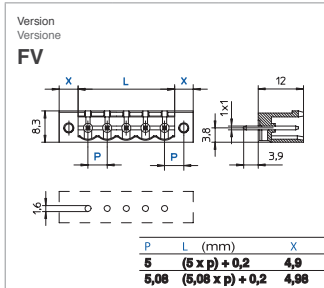

**CPM CPM..SQ\***

Single block · Blocco unico  
Monobloc · Einzelblock

Poles · Poli · Pôles · Polzahl

2/12



7,5 - 7,62
500
20

110
PA - UL 94 V0

V	A	mm²/AWG
500	20	0,2 ÷ 2,5
500	20	0,2 ÷ 2,5
300	12	24 ÷ 12

min 2 - max 12		
VE	/ on demand	GR GR1 NE AR BL RO GI
D/B4		

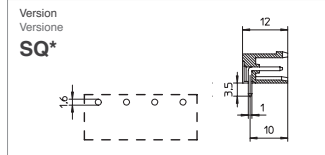
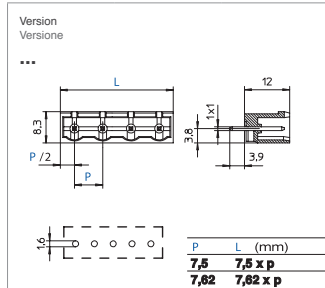

**CPM..A CPM..SQ\*A**

Single block · Blocco unico  
Monobloc · Einzelblock

Poles · Poli · Pôles · Polzahl

2/12



7,5 - 7,62
500
20

110
PA - UL 94 V0

V	A	mm²/AWG
500	20	0,2 ÷ 2,5
500	20	0,2 ÷ 2,5
300	12	24 ÷ 12

min 2 - max 12		
VE	/ on demand	GR GR1 NE AR BL RO GI
D/B4		

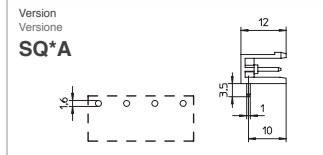
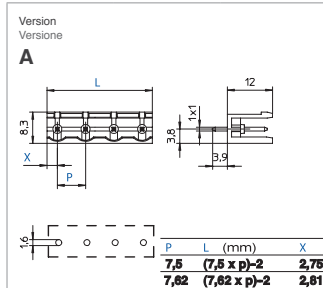

**CPM CPM..SQ\***

Single block · Blocco unico  
Monobloc · Einzelblock

Poles · Poli · Pôles · Polzahl

2/12



10 - 10,16
630
20

110
PA - UL 94 V0

V	A	mm²/AWG
630	20	0,2 ÷ 2,5
630	20	0,2 ÷ 2,5
300	12	24 ÷ 12

min 2 - max 12		
VE	/ on demand	GR GR1 NE AR BL RO GI
D/B4		

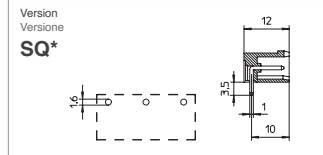
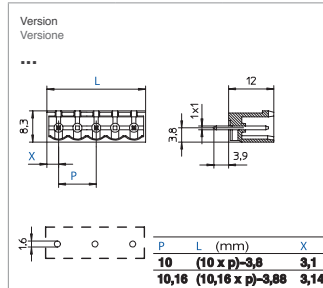

**CPM..A CPM..SQ\*A**

Single block · Blocco unico  
Monobloc · Einzelblock

Poles · Poli · Pôles · Polzahl

2/12



10 - 10,16
630
20

110
PA - UL 94 V0

V	A	mm²/AWG
630	20	0,2 ÷ 2,5
630	20	0,2 ÷ 2,5
300	12	24 ÷ 12

min 2 - max 12		
VE	/ on demand	GR GR1 NE AR BL RO GI
D/B4		

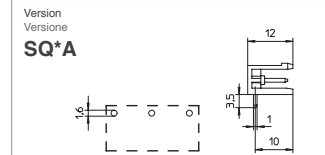
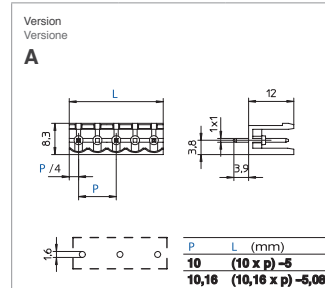

\* SQ Version = Horizontal version