

# MJE5740, MJE5742

MJE5742 is a Preferred Device

## NPN Silicon Power Darlington Transistors

The MJE5740 and MJE5742 Darlington transistors are designed for high-voltage power switching in inductive circuits.

### Features

- Pb-Free Packages are Available\*

### Applications

- Small Engine Ignition
- Switching Regulators
- Inverters
- Solenoid and Relay Drivers
- Motor Controls

### MAXIMUM RATINGS

Rating	Symbol	Value	Unit
Collector-Emitter Voltage MJE5740 MJE5742	$V_{CEO(sus)}$	300 400	Vdc
Collector-Emitter Voltage MJE5740 MJE5742	$V_{CEV}$	600 800	Vdc
Emitter-Base Voltage	$V_{EB}$	8	Vdc
Collector Current – Continuous – Peak (Note 1)	$I_C$ $I_{CM}$	8 16	Adc
Base Current – Continuous – Peak (Note 1)	$I_B$ $I_{BM}$	2.5 5	Adc
Total Device Dissipation @ $T_C = 25^\circ\text{C}$ Derate above $25^\circ\text{C}$	$P_D$	2 16	W W/ $^\circ\text{C}$
Total Device Dissipation @ $T_C = 25^\circ\text{C}$ Derate above $25^\circ\text{C}$	$P_D$	80 640	W W/ $^\circ\text{C}$
Operating and Storage Junction Temperature Range	$T_J, T_{stg}$	-65 to +150	$^\circ\text{C}$

### THERMAL CHARACTERISTICS

Characteristics	Symbol	Max	Unit
Thermal Resistance, Junction-to-Case	$R_{\theta JC}$	1.25	$^\circ\text{C/W}$
Thermal Resistance, Junction-to-Ambient	$R_{\theta JA}$	62.5	$^\circ\text{C/W}$
Maximum Lead Temperature for Soldering Purposes 1/8" from Case for 5 Seconds	$T_L$	275	$^\circ\text{C}$

Maximum ratings are those values beyond which device damage can occur. Maximum ratings applied to the device are individual stress limit values (not normal operating conditions) and are not valid simultaneously. If these limits are exceeded, device functional operation is not implied, damage may occur and reliability may be affected.

1. Pulse Test: Pulse Width = 5 ms, Duty Cycle  $\leq 10\%$ .

\*For additional information on our Pb-Free strategy and soldering details, please download the ON Semiconductor Soldering and Mounting Techniques Reference Manual, SOLDERRM/D.



ON Semiconductor®

<http://onsemi.com>

### POWER DARLINGTON TRANSISTORS 8 AMPERES 300-400 VOLTS 80 WATTS

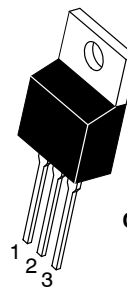
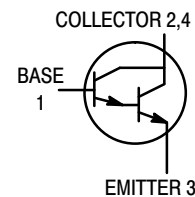
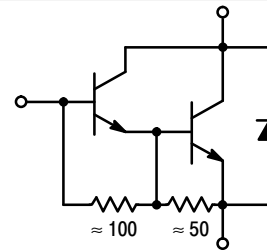

TO-220AB  
CASE 221A-09  
STYLE 1

### MARKING DIAGRAM

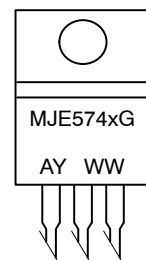

MJE574x = Device Code  
x = 0 or 2  
G = Pb-Free Package  
A = Assembly Location  
Y = Year  
WW = Work Week

### ORDERING INFORMATION

See detailed ordering and shipping information in the package dimensions section on page 2 of this data sheet.

Preferred devices are recommended choices for future use and best overall value.

# MJE5740, MJE5742

## ELECTRICAL CHARACTERISTICS (T<sub>C</sub> = 25°C unless otherwise noted)

Characteristic	Symbol	Min	Typ	Max	Unit
----------------	--------	-----	-----	-----	------

### OFF CHARACTERISTICS (Note 2)

Collector–Emitter Sustaining Voltage (I <sub>C</sub> = 50 mA, I <sub>B</sub> = 0)	MJE5740 MJE5742	V <sub>CEO(sus)</sub>	300 400	– –	– –	Vdc
Collector Cutoff Current (V <sub>CEV</sub> = Rated Value, V <sub>BE(off)</sub> = 1.5 Vdc) (V <sub>CEV</sub> = Rated Value, V <sub>BE(off)</sub> = 1.5 Vdc, T <sub>C</sub> = 100°C)		I <sub>CEV</sub>	– –	– –	1 5	mAdc
Emitter Cutoff Current (V <sub>EB</sub> = 8 Vdc, I <sub>C</sub> = 0)		I <sub>EBO</sub>	–	–	75	mAdc

### SECOND BREAKDOWN

Second Breakdown Collector Current with Base Forward Biased	I <sub>S/b</sub>	See Figure 6			
Clamped Inductive SOA with Base Reverse Biased	RBSOA	See Figure 7			

### ON CHARACTERISTICS (Note 2)

DC Current Gain (I <sub>C</sub> = 0.5 Adc, V <sub>CE</sub> = 5 Vdc) (I <sub>C</sub> = 4 Adc, V <sub>CE</sub> = 5 Vdc)	h <sub>FE</sub>	50 200	100 400	– –	–
Collector–Emitter Saturation Voltage (I <sub>C</sub> = 4 Adc, I <sub>B</sub> = 0.2 Adc) (I <sub>C</sub> = 8 Adc, I <sub>B</sub> = 0.4 Adc) (I <sub>C</sub> = 4 Adc, I <sub>B</sub> = 0.2 Adc, T <sub>C</sub> = 100°C)	V <sub>CE(sat)</sub>	– – –	– – –	2 3 2.2	Vdc
Base–Emitter Saturation Voltage (I <sub>C</sub> = 4 Adc, I <sub>B</sub> = 0.2 Adc) (I <sub>C</sub> = 8 Adc, I <sub>B</sub> = 0.4 Adc) (I <sub>C</sub> = 4 Adc, I <sub>B</sub> = 0.2 Adc, T <sub>C</sub> = 100°C)	V <sub>BE(sat)</sub>	– – –	– – –	2.5 3.5 2.4	Vdc
Diode Forward Voltage (Note 3) (I <sub>F</sub> = 5 Adc)	V <sub>f</sub>	–	–	2.5	Vdc

### SWITCHING CHARACTERISTICS

#### Typical Resistive Load (Table 1)

Delay Time	(V <sub>CC</sub> = 250 Vdc, I <sub>C(pk)</sub> = 6 A I <sub>B1</sub> = I <sub>B2</sub> = 0.25 A, t <sub>p</sub> = 25 μs, Duty Cycle ≤ 1%)	t <sub>d</sub>	–	0.04	–	μs
Rise Time		t <sub>r</sub>	–	0.5	–	μs
Storage Time		t <sub>s</sub>	–	8	–	μs
Fall Time		t <sub>f</sub>	–	2	–	μs

#### Inductive Load, Clamped (Table 1)

Voltage Storage Time	(I <sub>C(pk)</sub> = 6 A, V <sub>CE(pk)</sub> = 250 Vdc I <sub>B1</sub> = 0.06 A, V <sub>BE(off)</sub> = 5 Vdc)	t <sub>sv</sub>	–	4	–	μs
Crossover Time		t <sub>c</sub>	–	2	–	μs

2. Pulse Test: Pulse Width 300 μs, Duty Cycle = 2%.

3. The internal Collector–to–Emitter diode can eliminate the need for an external diode to clamp inductive loads. Tests have shown that the Forward Recovery Voltage (V<sub>f</sub>) of this diode is comparable to that of typical fast recovery rectifiers.

### ORDERING INFORMATION

Device	Package	Shipping
MJE5740	TO–220	50 Units / Rail
MJE5740G	TO–220 (Pb–Free)	
MJE5742	TO–220	
MJE5742G	TO–220 (Pb–Free)	

# MJE5740, MJE5742

## TYPICAL CHARACTERISTICS

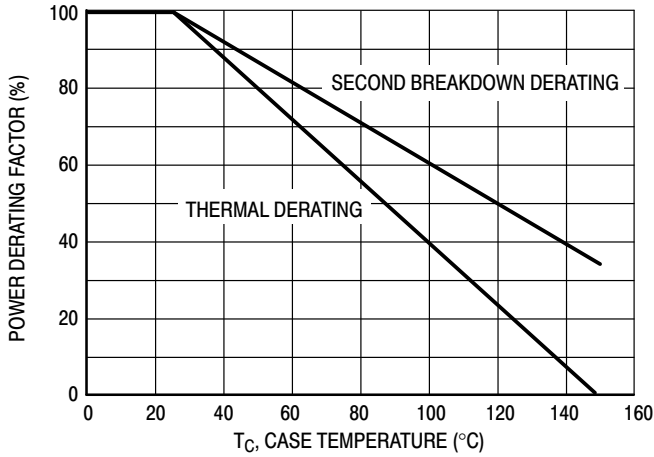

Figure 1. Power Derating

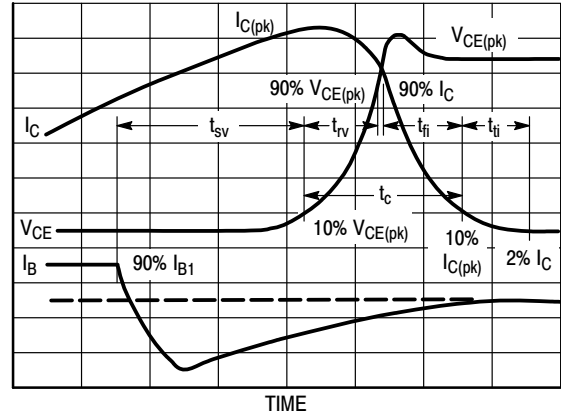

Figure 2. Inductive Switching Measurements

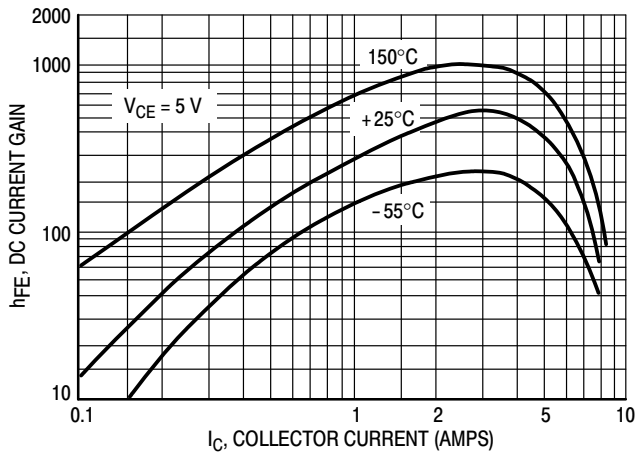

Figure 3. DC Current Gain

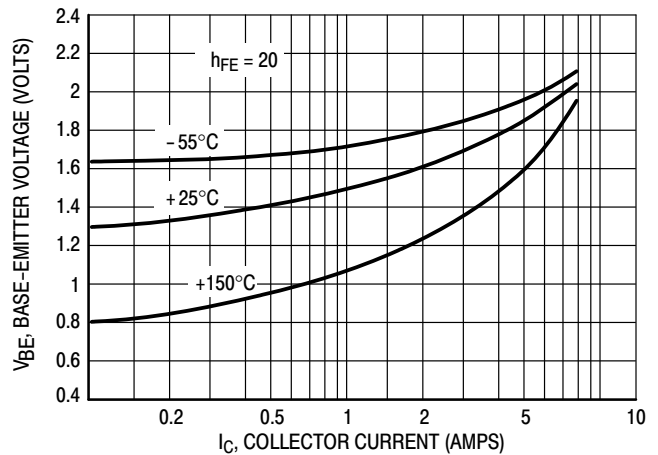

Figure 4. Base-Emitter Voltage

# MJE5740, MJE5742

Table 1. Test Conditions for Dynamic Performance

REVERSE BIAS SAFE OPERATING AREA AND INDUCTIVE SWITCHING		RESISTIVE SWITCHING
TEST CIRCUITS	<p>DUTY CYCLE <math>\leq</math> 10% <math>t_r, t_f \leq</math> 10 ns</p> <p>NOTE: PW and <math>V_{CC}</math> Adjusted for Desired <math>I_C</math> <math>R_B</math> Adjusted for Desired <math>I_{B1}</math></p>	<p>*SELECTED FOR <math>\geq</math> 1 kV</p>
CIRCUIT VALUES	<p>COIL DATA: FERROXCUBE CORE #6656 FULL BOBBIN (~16 TURNS) #16</p> <p>GAP FOR 200 <math>\mu</math>H/20 A <math>L_{coil} = 200 \mu</math>H</p> <p><math>V_{CC} = 30</math> V <math>V_{CE(pk)} = 250</math> Vdc <math>I_{C(pk)} = 6</math> A</p>	<p><math>V_{CC} = 250</math> V D1 = 1N5820 OR EQUIV.</p>
TEST WAVEFORMS	<p><b>OUTPUT WAVEFORMS</b></p> <p><math>t_1</math> ADJUSTED TO OBTAIN <math>I_C</math></p> $t_1 \approx \frac{L_{coil} (I_{C(pk)})}{V_{CC}}$ $t_2 \approx \frac{L_{coil} (I_{C(pk)})}{V_{clamp}}$ <p>TEST EQUIPMENT SCOPE-TEKTRONICS 475 OR EQUIVALENT</p>	<p><math>t_r, t_f &lt; 10</math> ns DUTY CYCLE = 1% <math>R_B</math> AND <math>R_C</math> ADJUSTED FOR DESIRED <math>I_B</math> AND <math>I_C</math></p>

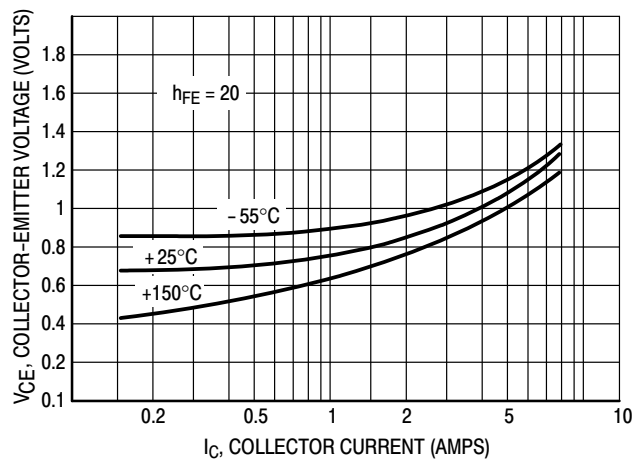

Figure 5. Inductive Switching Measurements

# MJE5740, MJE5742

## SAFE OPERATING AREA INFORMATION

### FORWARD BIAS

There are two limitations on the power handling ability of a transistor: average junction temperature and second breakdown. Safe operating area curves indicate  $I_C - V_{CE}$  limits of the transistor that must be observed for reliable operation; i.e., the transistor must not be subjected to greater dissipation than the curves indicate.

The data of Figure 6 is based on  $T_C = 25^\circ\text{C}$ ;  $T_{J(pk)}$  is variable depending on power level. Second breakdown pulse limits are valid for duty cycles to 10% but must be derated when  $T_C \geq 25^\circ\text{C}$ . Second breakdown limitations do not derate the same as thermal limitations. Allowable current at the voltages shown on Figure 6 may be found at any case temperature by using the appropriate curve on Figure 1.

The Safe Operating Area figures shown in Figures 6 and 7 are specified ratings for these devices under the test conditions shown.

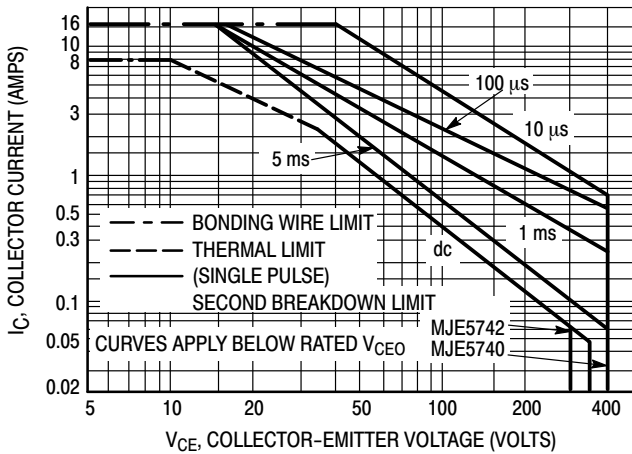

Figure 6. Forward Bias Safe Operating Area

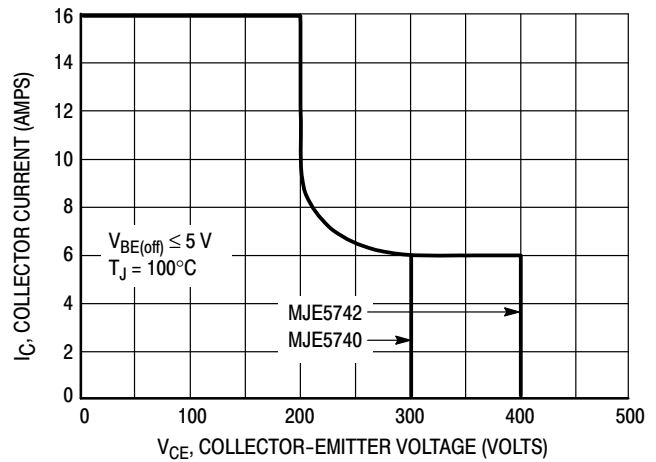

Figure 7. Reverse Bias Safe Operating Area

## RESISTIVE SWITCHING PERFORMANCE

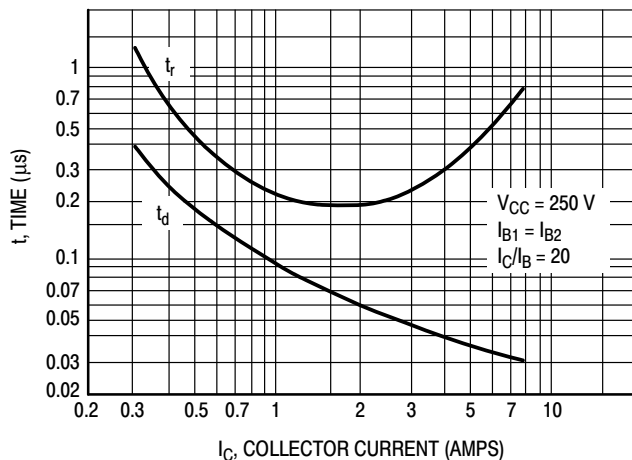

Figure 8. Turn-On Time

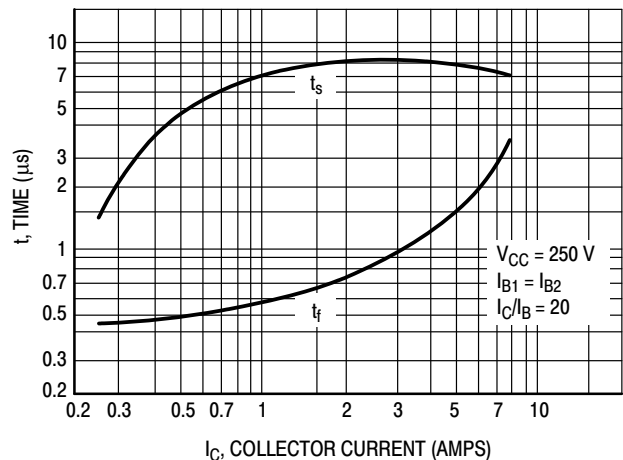
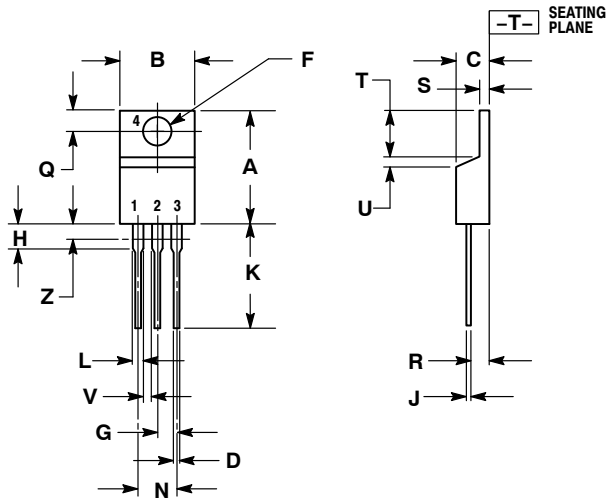

Figure 9. Turn-Off Time

# MJE5740, MJE5742

## PACKAGE DIMENSIONS

TO-220AB  
CASE 221A-09  
ISSUE AA



**NOTES:**

1. DIMENSIONING AND TOLERANCING PER ANSI Y14.5M, 1982.
2. CONTROLLING DIMENSION: INCH.
3. DIMENSION Z DEFINES A ZONE WHERE ALL BODY AND LEAD IRREGULARITIES ARE ALLOWED.

DIM	INCHES		MILLIMETERS	
	MIN	MAX	MIN	MAX
A	0.570	0.620	14.48	15.75
B	0.380	0.405	9.66	10.28
C	0.160	0.190	4.07	4.82
D	0.025	0.035	0.64	0.88
F	0.142	0.147	3.61	3.73
G	0.095	0.105	2.42	2.66
H	0.110	0.155	2.80	3.93
J	0.018	0.025	0.46	0.64
K	0.500	0.562	12.70	14.27
L	0.045	0.060	1.15	1.52
N	0.190	0.210	4.83	5.33
Q	0.100	0.120	2.54	3.04
R	0.080	0.110	2.04	2.79
S	0.045	0.055	1.15	1.39
T	0.235	0.255	5.97	6.47
U	0.000	0.050	0.00	1.27
V	0.045	---	1.15	---
Z	---	0.080	---	2.04

**STYLE 1:**

- PIN 1: BASE  
2. COLLECTOR  
3. EMITTER  
4. COLLECTOR

**ON Semiconductor** and **ON** are registered trademarks of Semiconductor Components Industries, LLC (SCILLC). SCILLC reserves the right to make changes without further notice to any products herein. SCILLC makes no warranty, representation or guarantee regarding the suitability of its products for any particular purpose, nor does SCILLC assume any liability arising out of the application or use of any product or circuit, and specifically disclaims any and all liability, including without limitation special, consequential or incidental damages. "Typical" parameters which may be provided in SCILLC data sheets and/or specifications can and do vary in different applications and actual performance may vary over time. All operating parameters, including "Typicals" must be validated for each customer application by customer's technical experts. SCILLC does not convey any license under its patent rights nor the rights of others. SCILLC products are not designed, intended, or authorized for use as components in systems intended for surgical implant into the body, or other applications intended to support or sustain life, or for any other application in which the failure of the SCILLC product could create a situation where personal injury or death may occur. Should Buyer purchase or use SCILLC products for any such unintended or unauthorized application, Buyer shall indemnify and hold SCILLC and its officers, employees, subsidiaries, affiliates, and distributors harmless against all claims, costs, damages, and expenses, and reasonable attorney fees arising out of, directly or indirectly, any claim of personal injury or death associated with such unintended or unauthorized use, even if such claim alleges that SCILLC was negligent regarding the design or manufacture of the part. SCILLC is an Equal Opportunity/Affirmative Action Employer. This literature is subject to all applicable copyright laws and is not for resale in any manner.

### PUBLICATION ORDERING INFORMATION

**LITERATURE FULFILLMENT:**  
Literature Distribution Center for ON Semiconductor  
P.O. Box 5163, Denver, Colorado 80217 USA  
**Phone:** 303-675-2175 or 800-344-3860 Toll Free USA/Canada  
**Fax:** 303-675-2176 or 800-344-3867 Toll Free USA/Canada  
**Email:** orderlit@onsemi.com

**N. American Technical Support:** 800-282-9855 Toll Free  
USA/Canada  
**Europe, Middle East and Africa Technical Support:**  
Phone: 421 33 790 2910  
**Japan Customer Focus Center**  
Phone: 81-3-5773-3850

**ON Semiconductor Website:** [www.onsemi.com](http://www.onsemi.com)  
**Order Literature:** <http://www.onsemi.com/orderlit>  
For additional information, please contact your local Sales Representative