

Series 1075 • 1075/G

- For use in burn-in and run-in test
- Transmission of high currents
- Low contact resistance

Mechanical Data

Center	5.00 mm/197 mil
Full Travel	5.50 (10.00 byCLX) mm
Working Travel	4.40 (8.00 byCLX) mm
Pre-loaded Spring Force	0.80/ 1.50/ 1.50/ 2.50 N
Spring Force at Working Travel	3.00/ 3.00/ 5.00/ 10.00 N

Electrical Data

Max. Current Rating	50.0 A
Typical Continuity Resistance	<= 5 mOhm

Materials

Barrel	Brass, gold plated
Spring	Stainless Steel, silver plated
Plunger	CuBe, gold plated/Silver Cap
Receptacle	Brass, gold plated

Recommended Diameter of Drill

mit Receptacle	
HP 2361.1 (Trolitax)	3.98...3.99 mm
HGW 2372	3.49...3.50 mm

Tip style - Diameter - Plating



AX	A6X	CLX	CX	DNX
4.00C Au	3.00C Au	4.00C Au	3.00C Au 4.00C Au	4.00C Ag

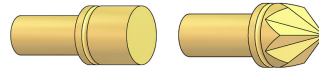

FX	KX
4.00C Au	3.00C Au

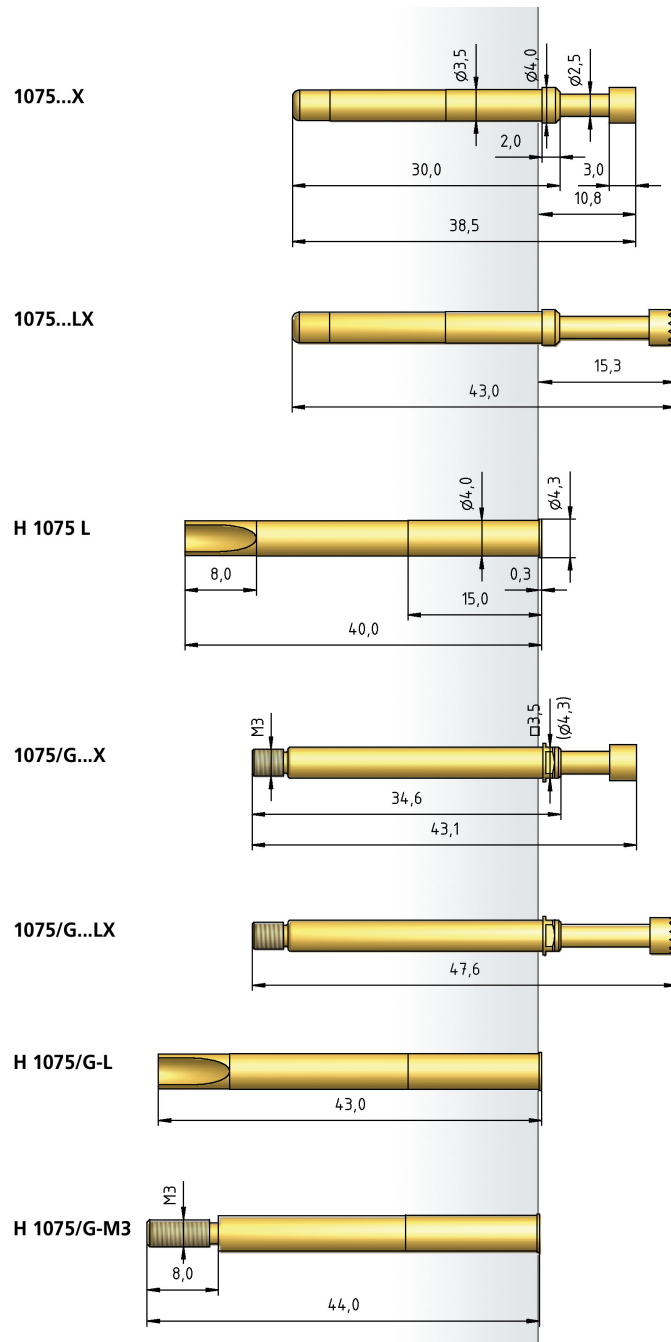

How to Order

1075/	G	FX	3.0 N	Au	4.0	C
1	2	3	4	5	6	7

1. Series 2. Threaded Design 3. Tip Style
4. Spring Force 5. Tip Plating 6. Tip Diameter
7. Tip Material (only for CuBe)