









C 091 A

- Screw locking according to IEC 61076-2-106
- Metal locking ring
- 2 - 8, 12 and 14 positions for crimp and solder
- IP 40
- Internal strain relief
- Male and female cable connectors straight and angled
- Male and female receptacles for front and rear panel mounting and PCB mounting
- Coloured back shells optional
- UL registered under file number E 63 093 UL

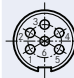
C 091 A Characteristics

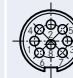
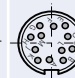
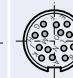
General Characteristics	Standard	Characteristics										
Number of contacts		2 ¹⁾ + 3	4	5	5 Stereo	6	7	7	8	12	14	
View on termination side of male contact insert												
Contact arrangement	DIN EN 61076-2-106	03-a	04-a	05-a	05-b	06-a	07-a	07-b	08-a	12-a	14-a	
Contact arrangement	IEC 60130-9 ²⁾	✓	✓		✓	✓		✓	✓			
Electrical Characteristics												
Rated voltage ³⁾	IEC 60664-1	300 V ≈ (100 V ≈)		300 V ≈ (63 V ≈)		100 V ≈ (32 V ≈)		300 V ≈ (63 V ≈)		100 V ≈ (32 V ≈)		150 V ≈ (32 V ≈)
Rated voltage	UL 1977	250 V									60 V	
Rated impulse withstand voltage ³⁾	IEC 60664-1	1500 V (840 V)			1200 V (500 V)		1500 V (840 V)			1200 V (500 V)		
Pollution degree ³⁾	IEC 60664-1	1 (2)										
Installation category	IEC 60664-1	I										
Insulation group	IEC 60664-1	II, 400 ≤ CTI < 600										
Current rating	IEC 60512-5-2 UL 1977	5 A / + 40 °C / + 104 °F please refer also to current derating curves page 59									3 A / + 40 °C / + 104 °F	
Insulation resistance	IEC 60512-3-1	> 10 ¹⁰ Ω ⁴⁾										
Contact resistance	IEC 60512-2-1	< 5 m Ω										
Climatic Characteristics												
Climatic category	IEC 60068-1	40 / 100 / 56										
Temperature range	IEC 60068-1	- 40 °C ... + 100 °C / - 40 °F ... + 212 °F										
Mechanical Characteristics												
IP-degree	IEC 60529	IP 40										
Insertion and withdrawal forces	IEC 60512-13-2	25 N 90.oz	30 N 110.oz	35 N 125.oz	50 N 180.oz	55 N 200.oz	60 N 220.oz	50 N 180.oz				
Mechanical operation	IEC 60512-9-1	Silver ≥ 500 mating cycles Gold ≥ 1000 mating cycles										
Materials												
Housing material		coupling ring brass, strain relief, die cast, nickel plated										
Dielectric material		thermoplastic										
Contact plating		silver plated / gold plated ⁵⁾										
Further Characteristics												
Termination technique		solder, crimp										
Wire gauge		solder: ≤ 0,5 mm ² / 20 AWG crimp: 2 - 6 pol (excluding 5S): 0,09 - 1,00 mm ² / 28 - 18 AWG crimp: 5S, 7, 7S and 8-pol.: 0,09 - 0,75 mm ² / 28 - 20 AWG									solder: ≤ 0,25 mm ² / 24 AWG crimp: 0,09-0,25 mm ² / 28 - 24 AWG	
Flammability		UL 94 V0										
Locking system	IEC 60130-9 DIN EN 61076-2-106	metal screw coupling; tightening torque 0,7 Nm										

Caution: Do not connect or disconnect under load. Metal housing parts shall be securely incorporated to protected ground.

¹⁾ 2 contact version: contact loading 1+3

²⁾ Edition 2000-05









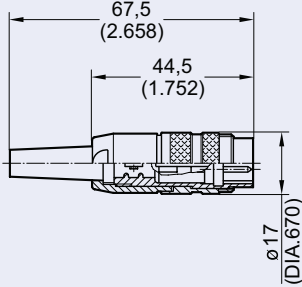

³⁾ values in brackets are according to DIN EN 61076-2-106

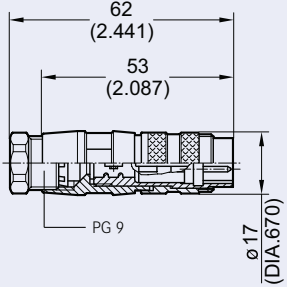
⁴⁾ under operating conditions >10⁸ Ω

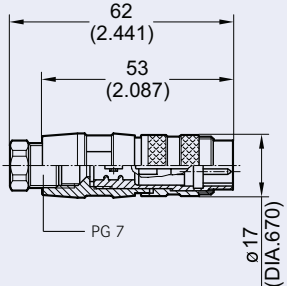
⁵⁾ Remark for gold plated contacts: In order to avoid brittle inter-metallic connections, gold-plated terminals have to be tin-plated in the solder area.

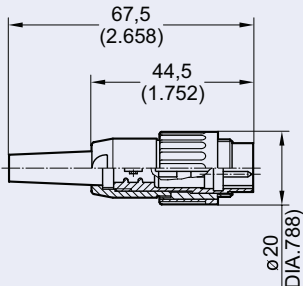
IEC 60 664 ≙ DIN VDE 0110; IEC 60 512-x ≙ DIN EN 60 512-x; IEC 60 130-9 ≙ DIN EN 60 130-9; IEC 61076-2-106 ≙ DIN EN 61076-2-106

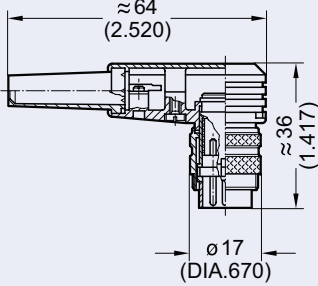
C 091 A Male cable connector

No. of cont.	Part Number solder termination		Part Number crimp termination	Drawing	Figure		
	silver plating	gold plating ¹⁾					
Straight (Please order crimp contacts separately, see page 56)							
2	T 3200 001	T 3200 018		 <p>for cable diameter 4-6mm</p>			
3	T 3260 001	T 3260 018	T 3260 551				
4	T 3300 001	T 3300 018	T 3300 551				
5	T 3360 001	T 3360 018	T 3360 551				
5S ²⁾	T 3360 010	T 3356 018 ³⁾	T 3356 551				
6	T 3400 001	T 3400 018	T 3400 551				
7	T 3475 001	T 3475 018	T 3475 551				
7 ²⁾	T 3484 001	T 3484 018 ³⁾	T 3484 551				
8	T 3504 001	T 3504 018	T 3504 551				
12	T 3635 001	T 3635 000	T 3635 551 ³⁾				
14	T 3650 001	T 3650 000	T 3650 551 ³⁾				
2	T 3200 002	T 3200 028				 <p>for cable diameter 6-8mm</p>	
3	T 3260 002	T 3260 028	T 3260 552				
4	T 3300 002	T 3300 028	T 3300 552				
5	T 3360 002	T 3360 028	T 3360 552				
5S ²⁾	T 3360 020	T 3356 028 ³⁾	T 3356 552 ³⁾				
6	T 3400 002	T 3400 028	T 3400 552				
7	T 3475 002	T 3475 028	T 3475 552				
7 ²⁾	T 3484 002	T 3484 028 ³⁾	T 3484 552				
8	T 3504 002	T 3504 028	T 3504 552				
12	T 3635 002	T 3635 002	T 3635 552 ³⁾				
14	T 3650 002	T 3650 002	T 3650 552 ³⁾				
2	T 3200 004	T 3200 048 ³⁾		 <p>for cable diameter 4-6mm</p>			
3	T 3260 004	T 3260 048 ³⁾	T 3260 554 ³⁾				
4	T 3300 004	T 3300 048 ³⁾	T 3300 554 ³⁾				
5	T 3360 004	T 3360 048	T 3360 554 ³⁾				
5S ²⁾	T 3356 004 ³⁾	T 3356 048 ³⁾	T 3356 554				
6	T 3400 004	T 3400 048 ³⁾	T 3400 554 ³⁾				
7	T 3475 004	T 3475 048 ³⁾	T 3475 554 ³⁾				
7 ²⁾	T 3484 004 ³⁾	T 3484 048 ³⁾	T 3484 554 ³⁾				
8	T 3504 004	T 3504 048 ³⁾	T 3504 554				
12	T 3635 004	T 3635 004	T 3635 554 ³⁾				
14	T 3650 004 ³⁾	T 3650 004 ³⁾	T 3650 554 ³⁾				
2	T 3200 013 ³⁾					 <p>for cable diameter 4-6mm</p>	
3	T 3260 013						
4	T 3300 013						
5	T 3360 013						
5S ²⁾	T 3360 130						
6	T 3400 013	T 3400 038					
7	T 3475 013 ³⁾	T 3475 038 ³⁾					
7 ²⁾	T 3484 013 ³⁾						
8	T 3504 013						
12							
14							
Right-angled (Please order crimp contacts separately, see page 56)							
2	T 3200 005			 <p>for cable diameter 4-6mm</p>			
3	T 3260 005	T 3260 058 ³⁾	T 3260 055				
4	T 3300 005	T 3300 058 ³⁾	T 3300 055 ³⁾				
5	T 3360 005	T 3360 058	T 3360 055				
5S ²⁾	T 3356 005	T 3356 058 ³⁾	T 3356 055 ³⁾				
6	T 3400 005	T 3400 058	T 3400 055 ³⁾				
7	T 3475 005	T 3475 058 ³⁾	T 3475 055 ³⁾				
7 ²⁾	T 3484 005	T 3484 058 ³⁾	T 3484 055 ³⁾				
8	T 3504 005	T 3504 058 ³⁾	T 3504 055				
12	T 3635 005	T 3635 058	T 3635 055 ³⁾				
14	T 3650 005	T 3650 058	T 3650 055 ³⁾				

C 091 A Male cable connector

Assembly instruction¹⁾, cable diameter 4-6mm

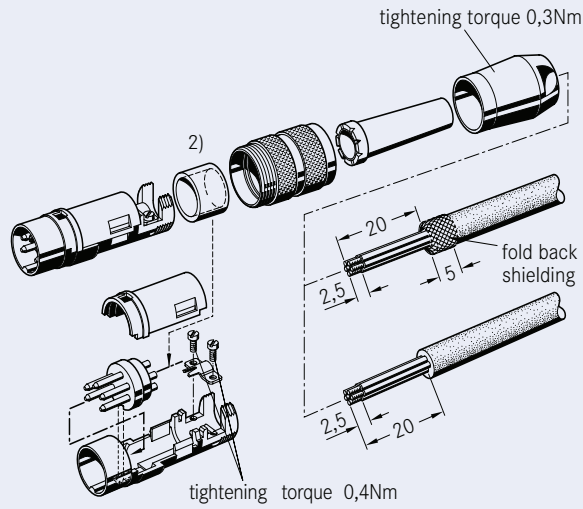

Assembly instruction¹⁾, cable diameter 4-6mm or 6-8mm

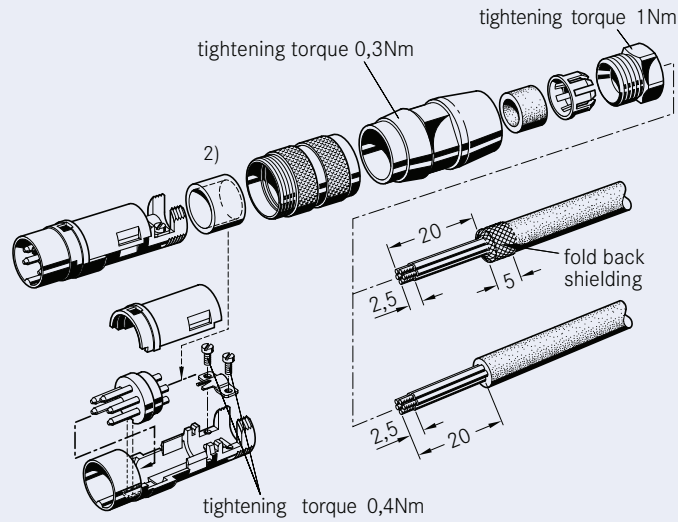

Assembly instruction¹⁾, right-angled, can be keyed to 8 angle positions

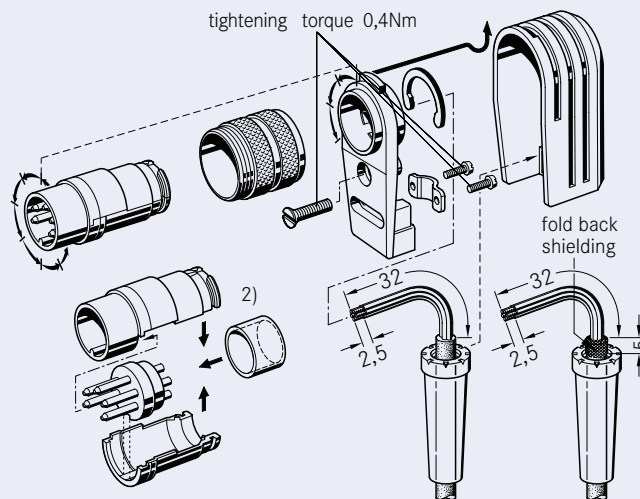

C 091 A Female cable connector

No. of cont.	Part Number		Part Number crimp termination	Drawing	Figure
	solder termination silver plating	gold plating ¹⁾			
Straight (Please order crimp contacts separately, see page 56)					
2 3 4 5 5S ²⁾ 6 7 7 ²⁾ 8 12 14	T 3201 001 T 3261 001 T 3301 001 T 3361 001 T 3361 010 T 3401 001 T 3476 001 T 3485 001 T 3505 001 T 3636 001 T 3651 001	T 3201 018 ³⁾ T 3261 018 T 3301 018 ³⁾ T 3361 018 T 3357 018 ³⁾ T 3401 018 T 3476 018 T 3485 018 ³⁾ T 3505 018 T 3636 000 T 3651 000	T 3261 551 T 3301 551 T 3361 551 T 3357 551 T 3401 551 T 3476 551 T 3485 551 T 3505 551 T 3636 551 ³⁾ T 3651 551 ³⁾		
2 3 4 5 5S ²⁾ 6 7 7 ²⁾ 8 12 14	T 3201 002 T 3261 002 T 3301 002 T 3361 002 T 3361 020 T 3401 002 T 3476 002 T 3485 002 T 3505 002 - -	T 3201 028 T 3261 028 T 3301 028 ³⁾ T 3361 028 T 3357 028 ³⁾ T 3401 028 T 3476 028 ³⁾ T 3485 028 ³⁾ T 3505 028 T 3636 002 T 3651 002	T 3261 552 ³⁾ T 3301 552 ³⁾ T 3361 552 T 3357 552 ³⁾ T 3401 552 ³⁾ T 3476 552 T 3485 552 ³⁾ T 3505 552 ³⁾ T 3636 552 ³⁾ T 3651 552 ³⁾		
2 3 4 5 5S ²⁾ 6 7 7 ²⁾ 8 12 14	T 3261 004 ³⁾ T 3301 004 T 3361 004 T 3357 004 ³⁾ T 3401 004 T 3476 004 ³⁾ T 3485 004 ³⁾ T 3505 004 T 3636 004 ³⁾ T 3651 004	T 3261 048 ³⁾ T 3301 048 ³⁾ T 3361 048 ³⁾ T 3357 048 ³⁾ T 3401 048 ³⁾ T 3476 048 ³⁾ T 3485 048 ³⁾ T 3505 048 ³⁾ T 3636 004 ³⁾ T 3651 004	T 3261 554 ³⁾ T 3301 554 T 3361 554 ³⁾ T 3357 554 T 3401 554 ³⁾ T 3476 554 ³⁾ T 3485 554 ³⁾ T 3505 554 T 3636 554 ³⁾ T 3651 554 ³⁾		
2 3 4 5 5S ²⁾ 6 7 7 ²⁾ 8 12 14	T 3201 013 ³⁾ T 3261 013 T 3301 013 ³⁾ T 3361 013 T 3361 130 T 3401 013 ³⁾ T 3476 013 T 3485 013 ³⁾ T 3505 013 T 3636 013	T 3476 038			
Right-angled (Please order crimp contacts separately, see page 56)					
2 3 4 5 5S ²⁾ 6 7 7 ²⁾ 8 12 14	T 3201 005 ³⁾ T 3261 005 T 3301 005 T 3361 005 T 3357 005 T 3401 005 T 3476 005 T 3485 005 T 3505 005 T 3636 005 T 3651 005	T 3261 058 ³⁾ T 3301 058 ³⁾ T 3361 058 ³⁾ T 3357 058 ³⁾ T 3401 058 T 3476 058 ³⁾ T 3485 058 ³⁾ T 3505 058 ³⁾ T 3636 058 T 3651 058 ³⁾	T 3261 055 ³⁾ T 3301 055 ³⁾ T 3361 055 T 3357 055 ³⁾ T 3401 055 T 3476 055 ³⁾ T 3485 055 T 3505 055 T 3636 055 ³⁾ T 3651 055 ³⁾		

C 091 A Female cable connector

Assembly instruction¹⁾, cable diameter 4-6mm

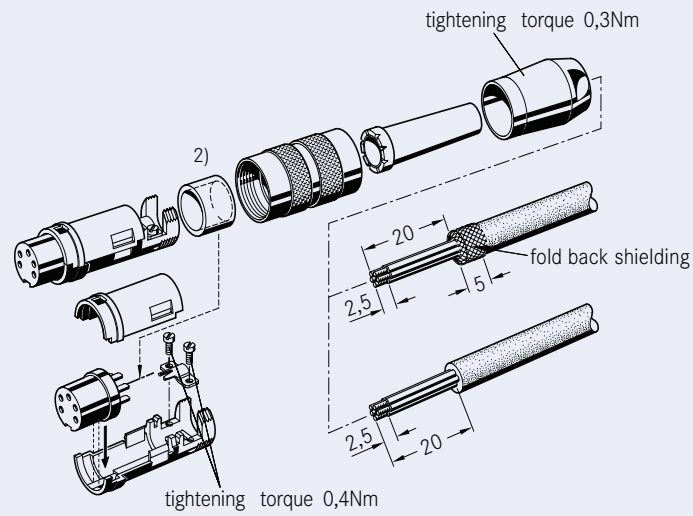

Assembly instruction¹⁾, cable diameter 4-6mm or 6-8mm

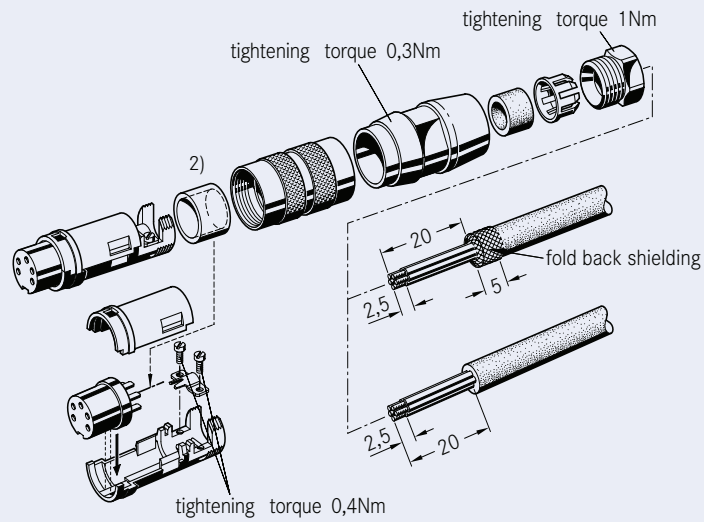

Assembly instruction¹⁾, right-angled, can be keyed to 8 angle positions

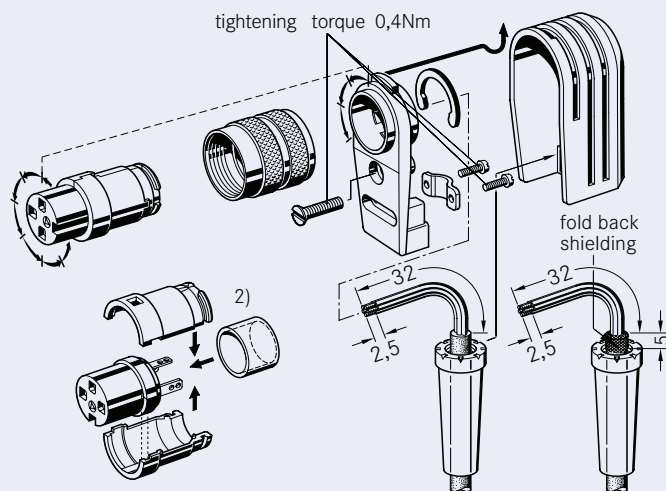

C 091 A Male receptacle | front mounting

No. of cont.	Part Number solder termination		Part Number crimp termination	Drawing	Figure
	silver plating	gold plating ¹⁾			

Ring Nut (Hex nut on request) (Please order crimp contacts separately, see page 56)

2	T 3202 000	T 3202 018	
3	T 3262 000	T 3262 018	T 3262 550 ³⁾
4	T 3302 000	T 3302 018	T 3302 550 ³⁾
5	T 3362 000	T 3362 018	T 3362 550 ³⁾
5S ²⁾	T 3362 010	T 3358 018 ³⁾	T 3358 550 ³⁾
6	T 3402 000	T 3402 018	T 3402 550
7	T 3477 000	T 3477 018	T 3477 550
7 ²⁾	T 3486 000	T 3486 018 ³⁾	T 3486 550 ³⁾
8	T 3506 000	T 3506 018 ³⁾	T 3506 550 ³⁾
12	T 3637 001	T 3637 000	T 3637 550 ³⁾
14	T 3652 001 ³⁾	T 3652 000	T 3652 550 ³⁾

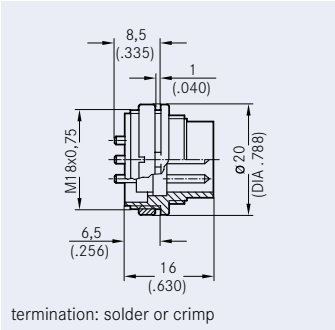

2			
3	T 3262 300 ³⁾		
4	T 3302 300 ³⁾		
5	T 3362 300 ³⁾		
5S ²⁾	T 3358 300 ³⁾		
6	T 3402 300 ³⁾		
7	T 3477 300 ³⁾		
7 ²⁾	T 3486 300 ³⁾		
8	T 3506 300 ³⁾		
12		T 3637 304 ³⁾	
14		T 3652 304 ³⁾	

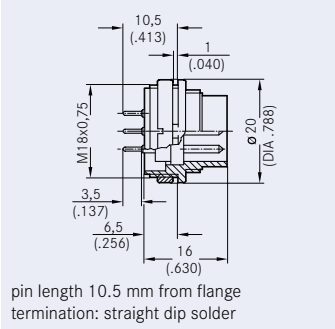

Assembly instruction⁴⁾

Panel cutout

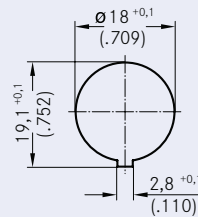
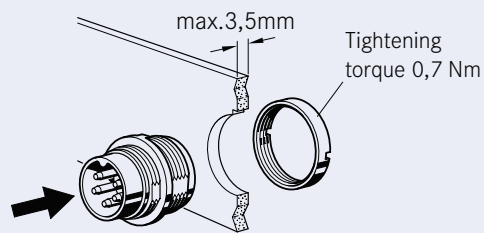

PCB-Layout (components side of circuit board)

Male Receptacles | front mounting | rear mounting | straight

3 POL

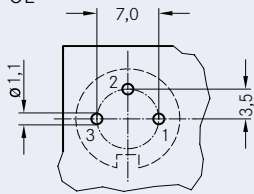

4 POL

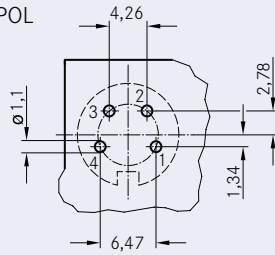

5 POL

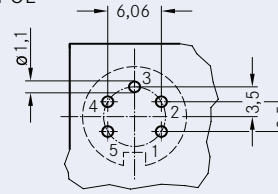

5 POL S ¹⁾

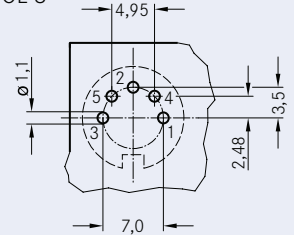

6 POL

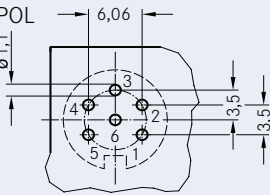

7 POL

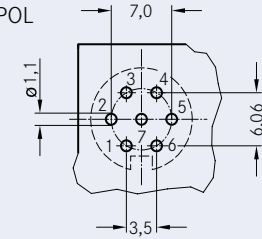

7 POL ¹⁾

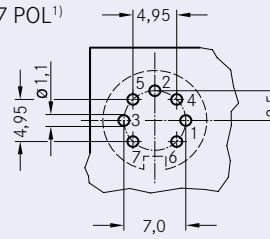

8 POL

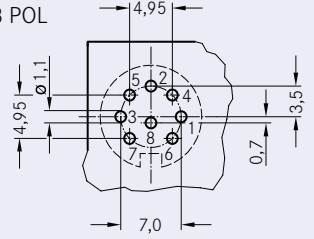



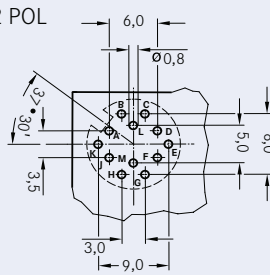



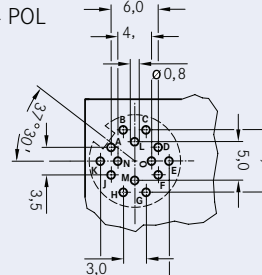

12 POL

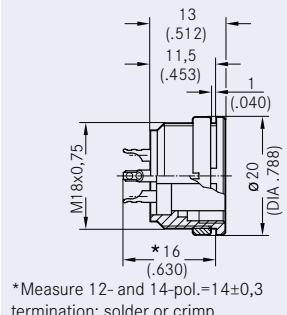

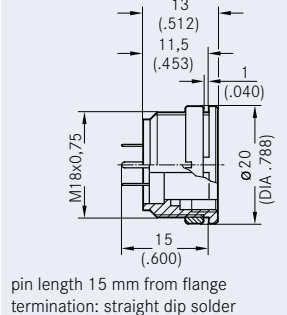
14 POL

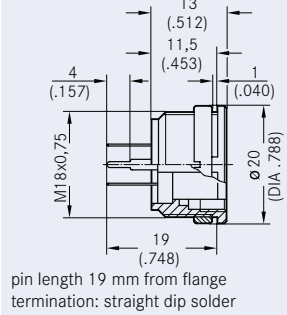

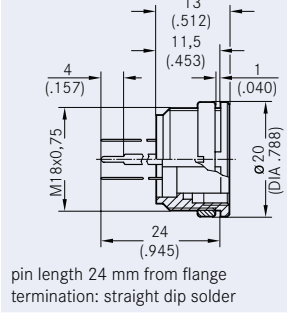
C 091 A Female receptacle | front mounting

No. of cont.	Part Number solder termination		Part Number crimp termination	Drawing	Figure		
	silver plating	gold plating ¹⁾					
Ring Nut (Hex nut on request) (Please order crimp contacts separately, see page 56)							
2	T 3203 000	T 3203 018					
3	T 3263 000	T 3263 018	T 3263 550				
4	T 3303 000	T 3303 018	T 3303 550				
5	T 3363 000	T 3363 018	T 3363 550				
5S ²⁾	T 3363 010	T 3359 018	T 3359 550 ³⁾				
6	T 3403 000	T 3403 018	T 3403 550				
7	T 3478 000	T 3478 018	T 3478 550				
7 ²⁾	T 3487 000	T 3487 018 ³⁾	T 3487 550				
8	T 3507 000	T 3507 018	T 3507 550 ³⁾				
12	T 3638 000	T 3638 004	T 3638 550 ³⁾				
14	T 3653 000	T 3653 004	T 3653 550 ³⁾				
2							
3	T 3263 300 ³⁾						
4	T 3303 300 ³⁾						
5	T 3363 300						
5S ²⁾	T 3359 300						
6	T 3403 300						
7	T 3478 300						
7 ²⁾	T 3487 300						
8	T 3507 300						
12		T 3638 304 ³⁾					
14		T 3653 304 ³⁾					
2							
3	T 3263 320 ³⁾						
4	T 3303 320						
5	T 3363 320						
5S ²⁾	T 3359 320 ³⁾						
6	T 3403 320						
7	T 3478 320						
7 ²⁾	T 3487 320 ³⁾						
8	T 3507 320 ³⁾						
12							
14							
2							
3	T 3263 330 ³⁾						
4	T 3303 330 ³⁾						
5	T 3363 330 ³⁾						
5S ²⁾	T 3359 330 ³⁾						
6	T 3403 330						
7	T 3478 330 ³⁾						
7 ²⁾	T 3487 330 ³⁾						
8	T 3507 330 ³⁾						
12							
14							

Assembly instruction⁴⁾

Panel cutout

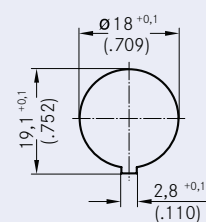
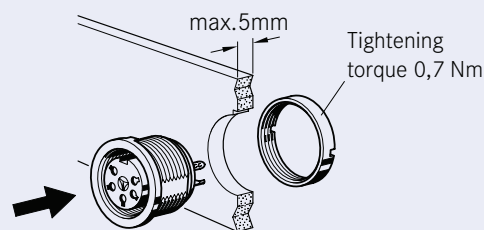

C 091 A Female receptacle | rear mounting



No. of cont.	Part Number solder termination		Part Number crimp termination	Drawing	Figure		
	silver plating	gold plating ¹⁾					
Ring Nut (Hex nut on request) (Please order crimp contacts separately, see page 56)							
2	T 3203 100						
3	T 3263 100	T 3263 118 ³⁾	T 3263 150 ³⁾				
4	T 3303 100	T 3303 118 ³⁾	T 3303 150 ³⁾				
5	T 3363 100	T 3363 118 ³⁾	T 3363 150				
5S ²⁾	T 3359 100	T 3359 118 ³⁾	T 3359 150				
6	T 3403 100	T 3403 118 ³⁾	T 3403 150				
7	T 3478 100	T 3478 118 ³⁾	T 3478 150				
7 ²⁾	T 3487 100	T 3487 118 ³⁾	T 3487 150 ³⁾				
8	T 3507 100	T 3507 118 ³⁾	T 3507 150				
12	T 3638 100	T 3638 118 ³⁾	T 3638 150 ³⁾				
14	T 3653 100	T 3653 118	T 3653 150 ³⁾				
2	T 3203 400						
3	T 3263 400						
4	T 3303 400						
5	T 3363 400	T 3363 404 ³⁾					
5S ²⁾	T 3359 400						
6	T 3403 400						
7	T 3478 400	T 3478 404 ³⁾					
7 ²⁾	T 3487 400						
8	T 3507 400	T 3507 404					
12		T 3638 404					
14		T 3653 404					
2							
3	T 3263 420 ³⁾						
4	T 3303 420						
5	T 3363 420						
5S ²⁾	T 3359 420						
6	T 3403 420						
7	T 3478 420						
7 ²⁾	T 3487 420 ³⁾						
8	T 3507 420						
12							
14							
2							
3	T 3263 430	T 3263 434					
4	T 3303 430	T 3303 434					
5	T 3363 430	T 3363 434					
5S ²⁾	T 3359 430 ³⁾						
6	T 3403 430	T 3403 434					
7	T 3478 430	T 3478 434					
7 ²⁾	T 3487 430 ³⁾						
8	T 3507 430						
12							
14							

Assembly instruction ⁴⁾

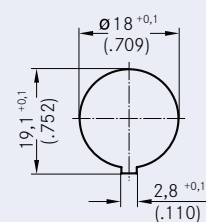
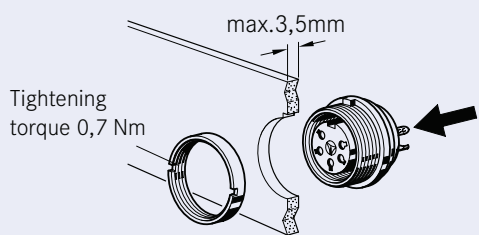

Panel cutout

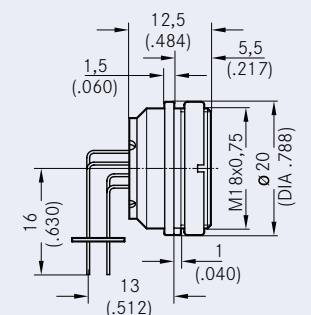

C 091 A Female receptacle | 90° | rear mounting

No. of cont.	Part Number solder termination		Part Number crimp termination	Drawing	Figure
	silver plating	gold plating ¹⁾			
Right-angled Ring Nut (Hex nut on request)			(Please order crimp contacts separately, see page 56)		
2					
3					
4					
5		T 3363 902			
5S ²⁾					
6		T 3403 902			
7					
7 ²⁾					
8					
12					
14					

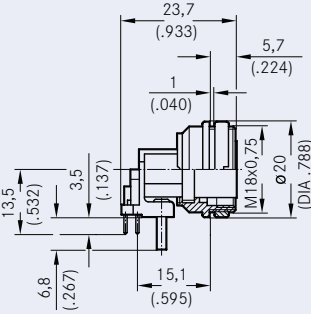
C 091 A Female receptacle | 90° | PCB mounting

No. of cont.	Part Number solder termination		Part Number crimp termination	Drawing	Figure
	silver plating	gold plating ¹⁾			
Right-angled Ring Nut (Hex nut on request)			(Please order crimp contacts separately, see page 56)		
2	T 3263 900				
3					
4					
5					
5S ²⁾	T 3359 900				
6					
7					
7 ²⁾	T 3487 900				
8	T 3507 900	T3507 902			
12					
14					

Panel cutout ⁴⁾ | Female receptacle | 90° | rear mounting | PCB mounting

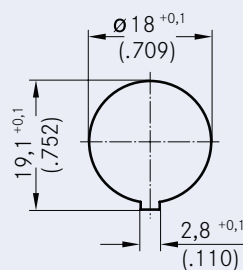

C 091 A Female receptacle | 90° | PCB flange mounting

No. of cont.	Part Number		Part Number crimp termination	Drawing	Figure
	silver plating	gold plating ¹⁾			

Right-angled (Please order crimp contacts separately, see page 56)

2					
3					
4					
5		T 3363 218			
5S ²⁾		T 3403 218			
6					
7					
7 ²⁾					
8					
12					
14					

Panel cutout³⁾ | Female receptacle | 90° | PCB flange mounting

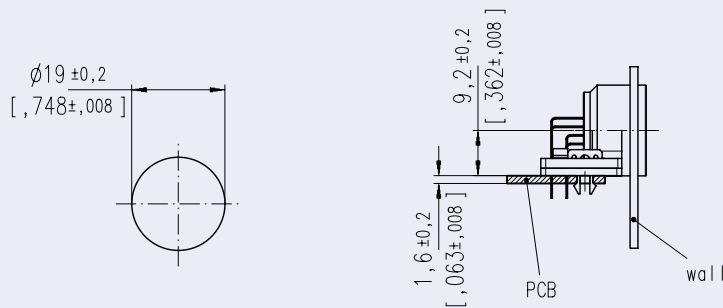

C 091 A Female receptacle | PCB-LAYOUT

PCB-LAYOUT (components side of circuit board)

Female receptacle | front mounting | rear mounting

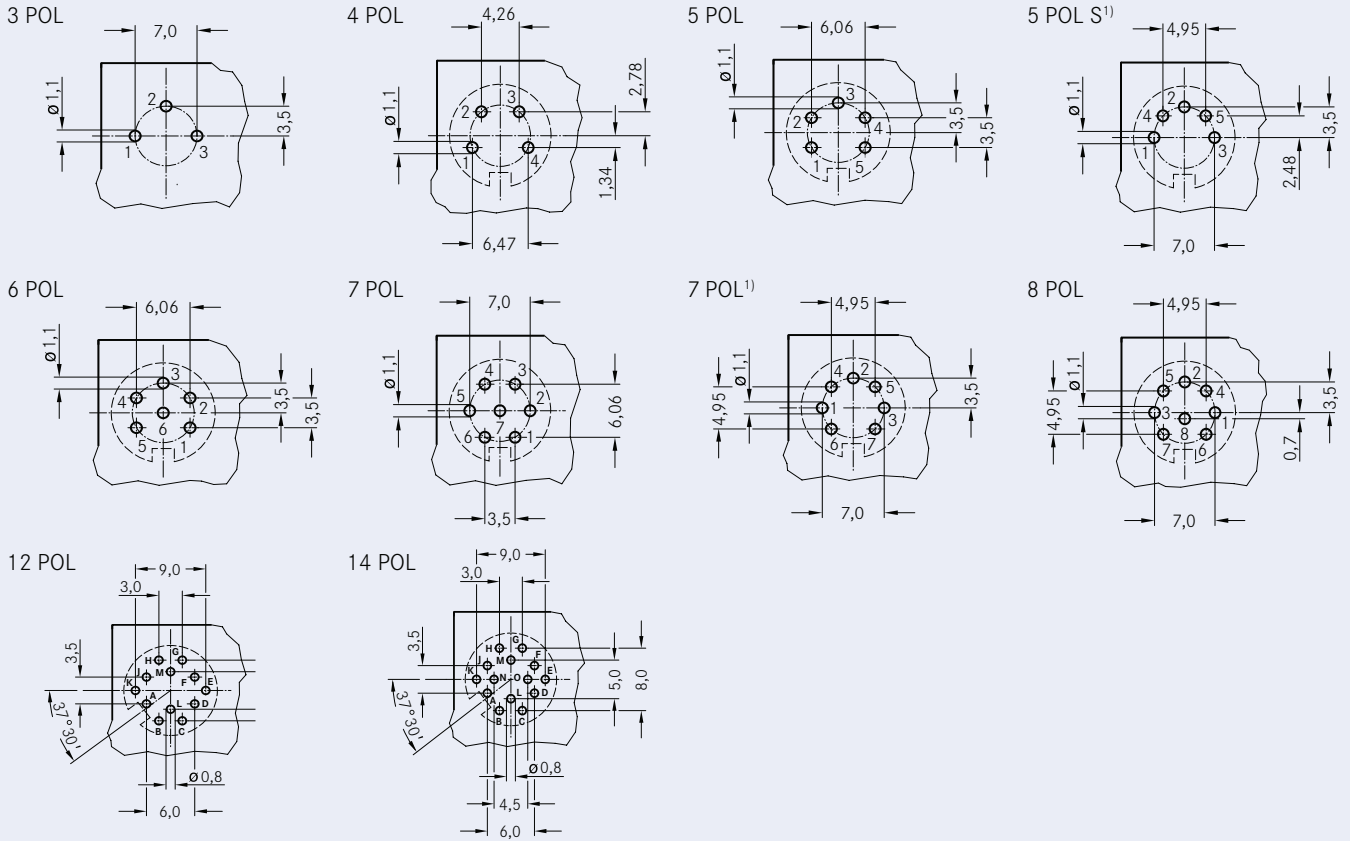

Female receptacle | 90° | rear mounting

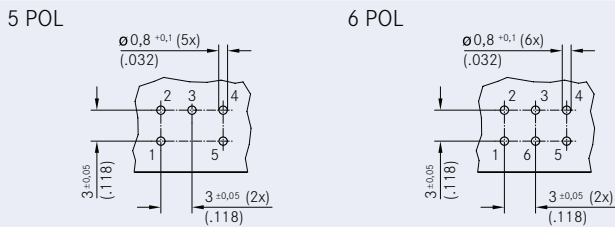

Female receptacle | 90° | PCB mounting

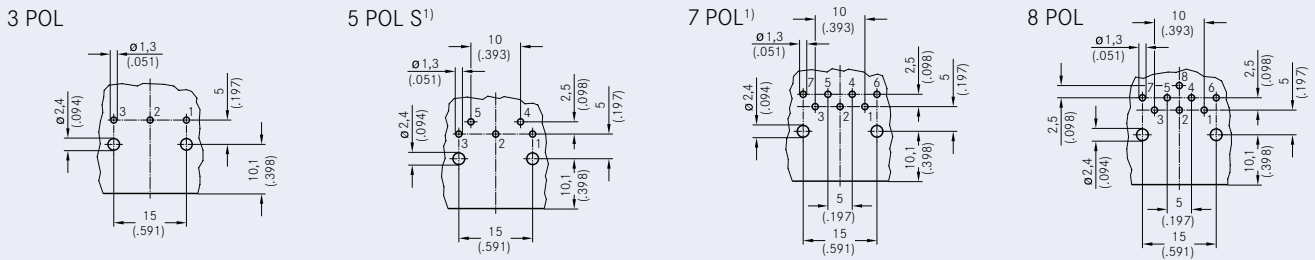

Female receptacle | 90° | PCB flange mounting

